

Copied 4-30-1919.

A L H

JUL 29 1918

SEP 27 1918

OCT 13 1918

(4-683.)

Platted

Mineral Survey No. 3500

Lot No. _____

Arizona

Land District.

FIELD NOTES

OF THE SURVEY OF THE MINING CLAIM OF

Daily Arizona Consolidated Copper Company

KNOWN AS THE

Copper Princess, Apache Central and Daily Tunnel Site lodes

Old Hat

_____ Mining District,

Pima

_____ County, Arizona

Section 16-17-20-21 ~~Unsurv~~ Township 11 S., Range 16 E.

Surveyed under instructions dated April 12, 1918,

by T.N. Stevens,

U. S. Deputy Mineral Surveyor.

Claim located See location notices _____, 1918

Survey commenced April 25, _____, 1918

Survey completed April 28 _____, 1918

o 6-180

Address of claimant

Ralph W. Langworthy,
~~G.S. Hanceck, Attorney in fact,~~

Tucson, Ariz.

Survey No. 3500

Copper Princess Lode.

Beginning at Cor. No. 1 on line 4-1 Apache Central Lode of this survey, a concrete monument 12 ins. Sq. at base, 6 ins. Sq. at top by 18 ins. high, built on concrete base 14 ins. Sq. 12 ins. in the ground, with copper plate on top stamped with cross (X) CP-1-3500 whence the N.W. Cor. Sec. 21, T. 11 S., R. 16 E., G. & S.R.B.M., bears S. 41°-28' W., 196.78 ft.

An oak 8 ins. diam. brs. S. 85° E., 5.5 ft. Blazed and scribed BT-CP-1-3500.

No other bearings available.

Feet

Thence S. 59°-16' W.

Va. 13°-30' E.

300.0 Center road brs. S. 10° W.

325.11 South end center, An oak post 3 ins Sq by 4 ft long set in md of stone 3 1/2 ft base by 3 ft high, scribed S. Cr. CP.

650.22 To Cor. No. 2, a concrete monument 12 ins. Sq. at base, 6 ins. Sq. at top by 18 ins. high, built on concrete base 14 ins. Sq., 12 ins. in the ground, with copper plate on top stamped with cross (X) CP-2-3500

No bearings are available.

Thence N. 5°-12' E.

Va. 13°-30' E.

1235.26³⁶ Intersect line 4-1 Golden Peak No. 2 lode, Sur. No. 3017, Copper Queen Consolidated Mining Co., claimant at S. 58°-46'-30" W., 84.77² ft. from Cor. No 4, and N. 58°-46'-30" E., 504.86⁴⁹ ft. from Cor. No. 1.

1236.18 To Cor. No. 3, a concrete monument 12 ins. sq. at base, 6 ins. sq. at top by 18 ins. high, built on concrete base 14 ins. Sq., 12 ins. in the ground, with copper plate on top stamped with cross (X) CP-3-3500.

No bearings are available.

Thence N. 59°-16' E.

Va. 13°-30' E.

84.24 To Cor. No.1 Copper Peak lode Sur. No.3017 identical with Cor. No. 4 Golden Peak No.2 lode of the same survey.

325.11 To N. end center, an oak post 4 ins sq by 4 ft. long set in md of stone 3 1/2 ft base by 3 ft high, scribed N. Cr. CP.

650.22 To Cor. No.4, identical with Cor. No.4 Apache Central lode of this survey, A concrete monument 12 ins.Sq. at base, 6 ins. Sq. at

Survey No. 3500

Copper Princess Lode-Continued.

- top by 18 ins. high, built on concrete base 14 ins. Sq. 12 ins. in the ground, with copper plate on top stamped with cross (X) CP-4, AC-4-3500
An oak 10 ins. in Diam. brs. N.61°-01' E., 10.3 ft. Blazed and scribed BT-CP-4 AC-4-3500.
- Feet No other bearings are available.
- Thence S.5°-12' W.
- Va. 13°-30' E.
- 1136.0 Center road brs. S.45° W.
- 1236.18 To Cor. No.1, the place of beginning.
- Apache Central Lode.
- Beginning at Cor. No.1
- Identical with Cor. No.1 Daily Tunnel Site Lode of this survey,
A concrete monument 12 ins. Sq. at base, 6 ins. Sq. at top by 18 ins. high, built on concrete base 14 ins. Sq., 12 ins. in the ground, with copper plate on top stamped with cross (X) AC-1-DT 1-3500, whence the N.W. Cor. Sec. 21, T.11 S., R. 16 E. G & S.R.B.M. bears N.43°-31' W., 154.94 ft.
- An oak 5 ins. Diam. brs. S.88° E., 6.4 ft. Blazed and scribed BT-AC 1-DT 1-3500.
- No other bearings are available.
- Thence N. 59°-16' E.
- Va. 13°-30' E.
- 219.89 Intersects N. body Sec. 21 at E. 295.61 ft. from N.W. Cor. said Sec. and 2344.39 ft. from N. 1/4 cor. thereof.
- 370.50 To S. end center, an oak post 4 ins Sq by 4 ft. long surrounded with md of stone 3 1/2 ft base by 3 ft high, scribed S Cr.AC.
- 732.22 To Cor. No.2
- A concrete monument 12 ins. Sq. at base, 6 ins. Sq. at top by 18 ins. high, built on concrete base 14 ins. Sq. 12 ins. in the ground, with copper plate on top stamped with cross (X) AC-2-3500
- No bearings are available.
- Thence N.1°-29'-41"E.
- Va. 13°-30' E.
- 136.58 Intersect S. end line Lone Buck Lode unsurveyed, J.W. Garden, claimant at N. 76°-17' E. 55.37 from S.W. Cor.
- 480.00 Center road brs. S 45° W.
- 720.00 Center road brs. S. 46° W.

Survey No. 3500 - Continued

Apache Central Lode- Cont'd.

Feet

1436.32

To Cor. No.3, Identical with Cor. No.4 York Lode, Sur. No.3017

A pine post 4 ft. long, 4 ins. square, set firmly in the ground surrounded with mound of stone, scribed 4-3017 on N.W. face, AC3-3500 on S.W. face.

An oak 12 ins. diam. brs. N. 60°-16' E. 13.0 ft.

An oak 14 ins. diam. brs. S. 84°-56' W., 43.9 ft. Both blazed and scribed B.T. 4-3017, 3-3500.

No other bearings are available.

Thence S. 59°-16' W.

Va. 13°-30' E.

13.21

Intersect W. side line Lone Buck Lode, ^{unsur.} at S. 3°-21' W. 140.35 ft from

N.W. Cor. said claim. and N. 3°-21' E., 1307.85 ft. from S.W. Cor. thereof.

143.00

Center road brs. N. 50 W.

247.36

N. end center, a pine post 3 X 6 ins., 4 ft. long set firmly in the ground, surrounded with md. of stone. Scribed N. Cr. AC.

593.5

To Cor. No.1 York Lode, Sur. NO. 3017.
and Cor. 4 Copper Peak

617.85

To Cor. No. 4, identical with Cor. No. 4 Copper Princess Lode of this survey, heretofore described.

Thence S. 5°-12' W.

Va. 13°-30' E

1136.0

Center road brs. S. 45° W.

1236.18

To Cor. No. 1 Copper Princess Lode of this survey.

1384.24

Intersect N. boundary Sec. 21 at E. 116.91 ft. from N.W. Cor. said Sec. and 2523.09 ft. from N. 1/4 Cor. thereof.

1497.07

To Cor. No.1, the place of beginning.

Daily Tunnel Site Lode.

Beginning at Cor. No. 1.

Identical with Cor. No.1 Apache Central Lode of this survey, heretofore described, whence, N.W. Cor. Sec. 21, T11S., R.16E., G. & S.R.B., M. Brs. N. 43°-31' W., 154.94 ft.

Thence S. 5°-12' W.

Va. 13°-30' E

300.00

To W. end Center, a pine post 5 ins. diam., 4 ft. long set firmly in the ground and surrounded with md. of stone. Scribed W. Cr. DTS.

600.00

To Cor. No. 2 A granite rock 10 X 10 X 4 ins. set 12 ins. in the ground and chiseled with a cross (X) DTS, 2-3500, with md of stone 3 1/2 ft base by 3 ft. high alongside.

An oak 12 ins. diam. brs. N. 11°-48' W., 16 ft. blazed and scribed DTS, 2-3500-BT.

U.S. Mineral Monument No.1 Brs. S. 7°-38' E., 2162.15 ft.

Sur. No. 3500

Daily Tunnel Site Lode, Cont'd.

Feet

Thence N. 59°-16' E.

Va. 13°-30' E.

1389.1 Intersect N. boundary Sec. 21 at E. 1246.31 ft. from N.W. Cor. said Sec. and W. 1393.69 ft. from N. 1/4 Cor. thereof.

1500.0 To Cor. No. 3.

A granite rock 8 X 10 X 5 ins. set 12 ins. in the ground and chiseled with a cross (X) DTS, 3-3500 on N.W. face with md of stone 3 1/2 ft base by 3 ft high alongside.

An oak 5 ins. Diam. Brs. S. 8°-18' E., 9.0 ft. blazed and scribed B.T. 3-3500

No other bearings are available
Thence N. 5°-12' E.

Va. 15°-30' E

300.0 To E. end Center, a pine post 5 ins. diam. by 4 ft long, set firmly in the ground and surrounded with md. of stone, Scribed E. Cr. DTS.
600.0 To Cor. No. 4

A granite rock 8 X 10 X 10 ins. set 12 ins. in the ground and chiseled with a cross (X) DTS, 4-3500 on S.W. face with md of stone 3 1/2 ft. base by 3 ft. high alongside.

The S.E. Cor. Lone Buck Lode, unsurveyed, brs. S. 32°-46' W., 135.38 ft.

An oak 6 ins. Diam. Brs. N. 66° W. 5.0 ft. Blazed and scribed, DTS-4-3500 BT.

No other bearings are available.

Thence S. 59°-16' W

Va. 13°-30' E.

83.43 Intersect E^{unsur.} side line Lone Buck Lode^{unsur.} at N. 1°-15' E., 71.22 ft. from S.E. Cor.

318.53 Intersect S. end line Lone Buck Lode^{unsur.} at S. 76°-17' W., 206.41 ft. from S.E. Cor.

767.78 To Cor. No. 2 Apache Central Lode of this survey.

1280.11 Intersect N. boundary Sec. 21 at E. 295.61^{ft} from N.W. Cor. said Sec. and W. 2344.39 ft. from N. 1/4 Cor. thereof.

1500.0 To Cor. No. 1 the place of beginning.

Sur. No. 3500 Continued

Lode lines

As near as can be determined from the present developments the veins of the several locations embraced in this claim extend as follows from their respective discovery points:

Copper Princess Lode, 33 ft. S.5°-12'W., and 1203.18 ft. N.5°-12'E.

Apache Central Lode, 350 ft. N.5°-12'E., and 1147.07 ft. S.5°-12'W.

Daily Tunnel Site Lode, 700 ft. S.59°-16'W., and 800 ft. N.59°-16'E.

AREAS.	Acres
Total area Copper Princess Lode -----	14.941
Area in conflict with-	
Golden Peak No. 2 lode, Sur. No. 3017 -----	50.659 ^{.001} sq. ft.
Total area, Apache Central lode -----	18.785 ✓
Area in conflict with-	
Lone Buck lode, unsur. -----	0.961
Total area, Daily Tunnel Site lode -----	16.729 ✓
Area in conflict with-	
Lone Buck lode, unsur.	
Bull Frog lode -----	0.163 ✓

The survey of each lode of this location is identical with the respective amended location as staked upon the ground.

LOCATION.

This survey is located in the N.W. 1/4 Sec. 21, S.W. 1/4 Sec. 16, S.E. 1/4 Sec. 17, and the N.E. 1/4 of the N.E. 1/4 Sec. 20, unsurveyed, T.11 S., R.16 E., G.&S.R.B.[&]M., Within the Coronado Nat'l Forest.

(insert here pages 7, 8, 9, 10 & 11)

EXHIBITED BY THIS INSTRUMENT DOLLARS.

This statement will be admitted into separate records.

INSTRUMENT.

This survey was made with a Gurley mountain transit. The courses were deflected from the true meridian as determined by direct solar observations. The distances were measured with a 500 ft. steel tape.

REPORT.

The lode line of each location of this claim was run directly upon the ground, and the corners were established by running around the claim.

Sur. No. 3500.

Report-continued.

The N.W. Cor. Sec. 21, T.11S., R.16 E., G & S.R. B.M. is a porphyry stone 10 X 10 X 6 ins. chiseled with four notches on the east face and three notches on the south face, near it are 2 witness trees

blazed and scribed. This is the nearest corner of the public survey.

The N. 1/4 Cor. Sec. 21 is a quartzite rock 8x8x8 ins. above ground, chiseled 1/4 on N. face, near it is an oak tree blazed and scribed 1/4 -S - 21 - BT.

Sur. No. 3017, York, Copper Peak and Golden Peak No. 2 .

All of the corners are pine posts, properly set and scribed with

the number of the corner and the survey. I find all courses and distances to be correct as approved, except line 1-4 Golden Peak No. 2 S. 59-16 W., 587.7 which fails to furnish the course and distance and same are properly given in these field notes.

Loñe Buck lode, unsurveyed.

All of the corners are monuments of stone.

Note.- The amended location certificate of the Apache Central lode fails to furnish the distance of line 1-2 and the same is properly given in these field notes.

---000---

(not included in transcript)

Direct Solar observation taken April 24, 1918 at 9-41 A.M solar time

Sun bisected, Lat. 32-28' - Lon. 110-43'

Apparent Dec. April 24- ----- 12-40'-59"

Dif. in time 5h-05' ----- 4-12 "

declination-- 12-36'-47"

$$\sin 1/2 A = \frac{\sqrt{\sin(S-L)(S-H)}}{\cos L \cos H}$$

$$P = 90-12-37' = 77-23'$$

L = 32-28'

H = 52-59' Ver. ang. diminished by refraction.

P = 77-23'

2 162-50'

S = 81-25'

9.8774501

9.6777309

0.0738099

0.2203694

S-L = 48-57'

S-H = 28-26'

2 19.8493603

$$9.9246801 = 57-13'-20" = 1/2 A.$$

$$114-26'-40" = A.$$

180

114-26-40"

Course of sun----- S- 65-33-20" E.

124-49'

65-33'

Course of line 3-4 Apache Central lode---- S- 59-16 -W.

Set up at Cor. No.3- Angle from Sun to Cor. No.4 -124-49'

Sur. No. 3500 - continued.
Expenditure of Five Hundred Dollars.
COPPER PRINCESS

No. 1. The discovery shaft of the Copper Princess lode the center of which is the discovery point, on the lode line 33 ft. from the center of line 1-2, 4 X 6 ft., 10 ft. deep.

Value \$100.00

No. 2. A tunnel, the mouth of which bears from Cor. No. 1, N. 79°-30'W. 130 ft., 4 X 6 ft., running N. 32°W. 150 ft.

Value \$1500.00

No. 3. A cut, the mouth of which brs. from Cor. No. 1, S.74°-15'W. 305 ft., 6 ft. wide, 15 ft. face, running West 20 ft.

Value \$150.00

No. 4. A cut, the mouth of which brs. from Cor. No. 1, S.82°W. 335 ft., 5 ft. wide, 10 ft. face, running S.10°W. 29 ft.

Value \$ 150.00

No. 5. A cut, the mouth of which brs. from Cor. No. 1, N.46°-15'W. 320 ft., 4 ft. wide, 15 ft. face, running N.45°W. 22 ft.

Value \$150.00

No. 6. A trench, the east end of which brs. from Cor. No. 1, N.30°-45'W. 330 ft., 4 ft. wide, 4 ft. deep, running West 53 ft.

Value \$300.00

No. 7. A tunnel, the mouth of which brs. from Cor. No. 4, S.8°-30'W. 325 ft., 5 X 7 ft., running thence

Sta. 0	- N.35°-47'W.,	25.5 ft.	to	Sta. 1
" 1	- N.80°-35'W.,	17.8 ft.	" "	2
" 2	- S.86°-55'W.,	35.4 ft.	" "	3
" 3	- N.63°-01'W.,	18.5 ft.	" "	4
" 4	- N.48°-00'W.,	38.3 ft.	" "	5
" 5	- S.80°-50'W.,	45.7 ft.	" "	6
" 6	- S.88°-33'W.,	22.4 ft.	" "	8
" 8	- N.79°-37'W.,	32.4 ft.	" "	9
" 9	- S.10°-08'W.,	13.5 ft.	" "	10
" 9	- S.81°-08'W.,	17.0 ft.	" "	11
" 5	- N.14°-40'E.,	26.0 ft.	" "	7
" 7	- N.58°-30'W.,	42.2 ft.	" "	12

At Sta. 3 is an upraise, 5 X 7 ft., 40 ft. high.

At S.80°-50'W., 36 ft. from Sta 5 is a winze 5 X 7 ft., 35 ft. deep.

. At same point is an upraise 5 X 7 ft., 35 ft. high.

Sur. No. 3500 - continued.
Expenditure of Five Hundred Dollars - cont'd

At N. 14°-40'E., 12 ft. from Sta. 5, is an upraise
5 X 7 ft., 22 ft. high.

From upraise is a drift 4 X 6 ft., running 40 ft.

Value \$6000.00

An undivided 1/12 interest credited to this lode \$500.00

No. 8. A cut, the mouth of which brs. from Cor. No.
4, S.23°-05'W. 395 ft., 5 ft. wide, 10 ft. face, running
N.5°W. 42 ft.

Value \$300.00

No. 9. A cut, the mouth of which brs. from Cor. No.
4, S.25°-30'W. 300 ft., 5 ft. wide, 8ft. face, running
N.45°W. 12 ft.

Value \$ 80.00

No. 10. A cut, the mouth of which brs. from Cor. No.
4, S.27°-30'W. 280 ft., 5 ft. wide, 8 ft. face, running
N.40°W. 12 ft.

Value \$.80.00

No. 11. A cut, the mouth of which brs. from Cor. No.
4, S.22°-30'W. 235 ft., 5 ft. wide, 8 ft. face, running
N. 82°W. 20 ft.,

From mouth is another cut 5 ft. wide, 8 ft. face, run-
ning N. 10 ft.

Value \$150.00

No. 12. A cut, the mouth of which brs. from Cor. No.
4, S.18°W. 180 ft., 5 ft. wide, 8 ft. face, running
N.34°W. 40 ft.

Value \$200.00

APACHE CENTRAL.

No. 1 The discovery cut of the Apache Central lode,
the face of which is the discovery point, is on the lode
line 350 ft. from a point on line 3-4, 370⁴⁹ from Cor.

No. 4, 5 ft. wide, 6 ft. face, running S.66°E. 10 ft. to
mouth.

Value \$ 50.00

No. 2. A cut, the mouth of which brs. from Cor.
No. 4, S.31°-15'E. 270 ft., 4 ft. wide, 10 ft. face,

Sur. No. 3500 - continued.
 Expenditure of Five Hundred Dollars - cont'd.
 Apache Central - cont'd

running N. 15 ft. to face.

Value \$100.00

No. 3. A tunnel, the mouth of which brs. from Cor.

No. 4, S. 23° 00' E. 290 ft., 4 ft. wide, 8 ft. face, running
 N. 43° W. 6 ft., ~~6 ft.~~ to face.

From face is a tunnel 4 X 6 ft., running N. 43° W. 10 ft
 to face.

Value \$125.00

No. 4. A cut, the mouth of which brs. from Cor. No.

4, S. 3° 45' E. 465 ft., 7 ft. wide, 12 ft. face, running
 S. 17° W. 43.0 ft. to face.

From face is a tunnel 4 X 6 ft., running S. 17° W. 25 ft.
 to face.

Value \$300.00

Daily Tunnel Site.

No. 1. The discovery cut, the face of which being the
 discovery point, is on the lode line 700 ft. from the
 center of line 1-2, 4 ft. wide, 10 ft. face, running
 12 ft. to face.

Value \$100.00

No. 2. A cut, the mouth of which brs. from Cor. No. 1,
 East 590 ft., 4 ft. wide, 8 ft. face, running 25 ft. to face.

Value \$125.00

OTHER IMPROVEMENTS.

A shaft, the center of which brs. from Cor. No. 2,
 Copper Princess lode, N. 55° 30' E. 315 ft., 4 X 6 ft.
 10 ft. deep. From shaft is a tunnel 4 X 6 ft., running
 west 10 ft.

From shaft is a tunnel 4 X 6 ft., running South 10 ft.

A shaft, the center of which brs. from Cor. No. 1,
 S. 65° W. 330 ft., 4 X 6 ft., 10 ft. deep.

A tunnel, the mouth of which brs. from Cor. No. 1,
 Copper Princess lode, S. 66° 30' W. 325 ft., 4 X 6 ft.
 running N. 85° W. 85 ft. Thence N. 39° W. 45 ft.

A blacksmith shop, the N. E. Cor. of which brs. from

Sur. No. 3500 - continued.
Other Improvements - cont'd.

Cor. No. 4, Copper Princess lode, S.12°-30'W. 400 ft.,
12 ft. wide by 20 ft. long. Course of long sides,
N.85°W.

A compressor and boiler house, the N. E. Cor. of which
brs. from Cor. No. 4, Copper Princess lode, S.8°-15'W.
400 ft., 12 ft. wide by 40 ft. long. Course of long
sides S 36°-30'E.

A bunkhouse, the N. E. Cor. of which brs. from Cor.
No. 3, Apache Central lode, S.13°-15'W. 490 ft., 16 ft.
wide, by 40 ft. long. Course of long sides S.16°-30'W.

A mess house, the N.E. Cor. of which brs. from Cor. No.3,
Apache Central lode S.40°W., 67.0 ft. course of long sides
S.59°W.

A store, the N.E. Cor. of which brs. from Cor. No.3 Apache
Central lode, S. 57°W., 171.4 ft. Course of long sides S. 59°-16'W.

---oOo---

IMPROVEMENT NO 7 ON THE COPPER PRINCESS LODE.

This tunnel is in the course of construction for the development
of this claim and all of the eleven claims of Sur. No.3499, consisting
of -Daily No.3, Daily No.5, Sphinx, Roskrige, Calumet, Edith, Daily
Extension, Cave, Wedge No.3, Wedge No.2 and Katherine lodes, claimant
herein.

An undivided 1/12 interest in this tunnel, value \$500.00, has been
credited to each of the eleven mentioned lodes.

The surface embraced in the above claims ascends rapidly from the
mouth of the tunnel to the discoveries of the Daily Extension, Cave,
Wedge No.3, Wedge No.2 and Katherine lodes, which are from 800 to
1000 feet higher than the mouth of the tunnel.

The tunnel described and included in the estimate of expenditures,
continued in its present course, and by drifting and cross-cutting
therefrom in different directions towards and under the eleven

Sur. No.3500

IMPROVEMENT NO 7 ON THE COPPER PRINCESS LODE-Cont'd
claims of this group, the entire group may be advantageously developed and ore extracted therefrom. This improvement is, therefore, a common improvement for the benefit of the above mentioned claims. This tunnel cannot consistently be considered an improvement for the benefit and development of the Apache Central and Daily Tunnel Site lodes, as the surface of these claims lies below the portal and its course extends away from the claims.

An undivided 1/12 interest (\$ 500.00) in the value of this improvement is therefore properly credited to the Copper Princess lode.

The Copper Peak and Peacock, the intervening claims, together with the Copper Matt, are owned by E.O.Stratton, subject to an agreement to sell to the Daily Arizona Consolidated Copper Co. for \$20000.00. The deed from Stratton to the company and a certified check for \$20000.00 now being held in escrow by the Southern Arizona Bank and Trust Co., to be delivered upon the favorable termination of a certain suit now pending against Stratton clearing the title to the claims.

In case this agreement does not terminate favorably, condemnation proceedings will instituted to force a right of way through the intervening ground.

ADJOINING CLAIMS.

This group is bounded on the north by the Golden Peak No.2, Copper Peak and York lodes all of Sur. No.3017, Copper Queen Consolidated Mining Co. claimant.

On the east by the Lone Buck lode, Uns. J.W. Garden, Claimant.

On the south by the Copper Matt, Uns. E.O. Stratton, claimant.

On the west by the Peacock lode, Uns. E.O. Stratton, claimant.

FINAL OATHS FOR SURVEYS.

LIST OF NAMES.

A list of the names of the individuals employed by T.N.Stevens

United States Mineral Surveyor, to assist in running, measuring, and marking the lines, corners, and boundaries described in the foregoing field notes of the survey of the mining claim of

Daily Arizona Consolidated Copper Company

known as the Copper Princess, Apache Central and Daily Tunnel site Lodes

and showing the respective capacities in which they acted.

W.H.Coplen, Chainman.

....., Chainman.

....., Axman.

....., Flagman.

FINAL OATHS OF ASSISTANTS.

~~We~~ I, W.H.Coplen

and, do solemnly swear that ^Iwe assisted

T.N.Stevens, United States Mineral Surveyor, in marking the corners and surveying

the boundaries of the mining claim of Daily Arizona Consolidated Copper Company

known as the Copper Princess, Apache Central and Daily Tunnel Site Lodes

represented in the foregoing field notes as having been surveyed by said mineral surveyor and under his

direction; and that said survey has been in all respects, to the best of our knowledge and belief, faithfully

and correctly executed, and the corner and boundary monuments established according to law and the instruc-

tions furnished by the United States Surveyor-General for Arizona

W.H.Coplen, Chainman.

....., Chainman.

....., Axman.

....., Flagman

Subscribed and sworn to by the above-named person before me this 21st

day of May, 1918

*My Commission Expires
February 19-1920*

Geo. P. Meyers
Notary Public

FINAL OATH OF U. S. MINERAL SURVEYOR.

I, T.N. Stevens, U. S. Mineral Surveyor,
do solemnly swear that, in pursuance of instructions received from the United States
Surveyor General for Arizona, dated
April 12, 1918, I have, in strict conformity to the laws of the
United States, the official regulations and instructions thereunder, and the instructions
of said Surveyor General, faithfully and correctly executed the survey of the Mining
Claim of Daily Arizona Consolidated Copper Company
, known as the
Copper Princess, Apache Central and Daily Tunnel Site lodes
, situate in P Old Hat Mining District,
Pima County, Arizona, in Section^s
16-17-20-21, Unsur., Township No. 11 S., Range No. 16 E.
, and designated as Survey No. 3500, as represented
in the foregoing field notes, which accurately show the boundaries of said mining claim
as distinctly marked by monuments on the ground, and described in the attached copy
of the location certificate, which was received by me from the Surveyor General with
said instructions, and that all the corners of said survey have been established and per-
petuated in strict accordance with the law, official regulations and instructions there-
under; and I do further solemnly swear that the foregoing are the true and original
field notes of said survey and my report therein, and that the labor expended and
improvements made upon said mining claim by claimant or its grantors
are as therein fully stated, and that the character, extent, location, and itemized value
thereof are specified therein with particularity and full detail, and that no portion of
said labor or improvements so credited to this claim has been included in the estimate
of expenditures upon any other claim.

T. N. Stevens

U. S. Mineral Surveyor.

Subscribed and sworn to by the said T. N. Stevens

U. S. Mineral Surveyor, before me

day of June, 1918

this

8th

Geo P. Myers

Notary Public

My Commission Expires }
February 19, 1920 }

STATE OF ARIZONA, }
COUNTY OF PIMA. } ss.

I, R. B. Vinson, County Recorder in and for the
County of Pima, State of Arizona, do hereby certify that the above and foregoing is a full, true and correct copy
of Amended Location Notice of the Copper Princess Mining Claim
situated in the Old Hat Mining District, and now owned by Daily-
Arizona Consolidated Copper Company, dated Nov. 22nd, 1917
as appears of record now in my office in Book B. B. B. Record of Mines Pages 379

IN WITNESS WHEREOF, I have hereunto set my hand
and affixed my official seal, at my office in Tucson,
this Eighth day of
January, A. D. 1917
R. B. Vinson
County Recorder of Pima County, Arizona.

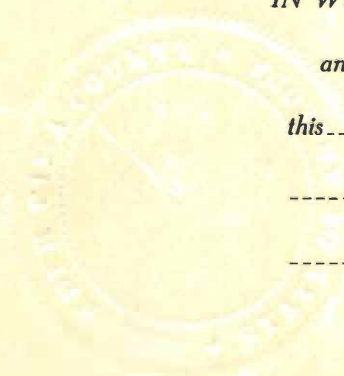

AMENDED

Notice of Mining Location

LODE CLAIM

TO ALL WHOM IT MAY CONCERN:

This Mining Claim, the name of which is the COPPER PRINCESS Mining Claim, situate on lands belonging to the United States of America, and in which there are valuable mineral deposits, was entered upon and located for the purpose of exploration and purchase by J. W. DAILY JR., a citizen of the United States grantor of

(Locator must insert either "a citizen of the United States," or "who has declared his intention to become a citizen of the United States.")

the undersigned, on the 1st day of January, 1914.

The length of the claim is 1236.18 feet, and we claim 33 feet,

in a S 5° 12' W direction and 1203.18 feet in a N 5° 12' E direction from

the center of the discovery shaft, at which this notice was posted, lengthwise of the claim, together with 300 feet in width of surface grounds, on each side

of the center of said claim. The general course of the lode deposit and premises is from the S 5° 12' W to the N 5° 12' E.

The Claim is situated and located in the OLD HAT Mining District, in Pima County in the State of Arizona, ~~XXXX~~

in a ~~direction~~ from S E Cor Claim N W Cor Sec 21, T 11 S, R 16 E, bears S 41° 28' W 196.78

The surface boundaries of the claim are marked upon the ground as follows: Beginning at South end center (A monument of stone)

at a point in a S 5° 12' W direction 33 feet from

the discovery shaft (at which this notice is posted), being in the center of the South end line of said claim; thence S 59° 16' W 325.11 feet to a Monument

, being the S W corner of said claim; thence N 5° 12' E 1236.18 feet to a Monument, being at the

N W corner of said claim; thence N 59° 16' E 325.11 feet to a Monument

at the center of the North end of said claim; thence N 59° 16' E 325.11 feet to a Monument being at the

N E corner of said claim; thence S 5° 12' W 1236.18 feet to a Monument

at the S E corner of said claim; thence S 59° 16' W 325.11 feet to the place of beginning.

All done under the provisions of Chapter Six, of Title XXXII, of the Revised Statutes of the United States, and of an Act of the General Assembly of Arizona, entitled "An Act to Revise and Codify the Laws of the Territory of Arizona," approved March 16, 1901.

This is an Amended Location Notice of the COPPER PRINCESS Mining Claim, located by J. W. Daily, Jr., Grantor of the undersigned owner

on the 1st day of January, 1914, and recorded in Book V V of Records of Mines, at

page 42, in the office of the County Recorder of the aforesaid County of to which reference is hereby made, and this amended Location Notice is made and posted to

correct errors in the description in the said original Location Notice

Dated and posted on the ground this 22nd day of Nov, 1917

DAILY-ARIZONA CONSOLIDATED COPPER COMPANY, (Present Owner)

By J. Hancock Its Attorney in Fact.

STATE OF ARIZONA,

County of _____ ss.

I _____, County Recorder in and for the County and State aforesaid, do hereby certify that the within instrument was filed for record at _____ o'clock _____ M., on this _____ day of _____ 19____, and duly recorded in book No. _____ of _____ Records of _____ County, Arizona, at pages _____

WITNESS my hand and official seal the year first above written.

Country Recorder.

AMENDED
Notice of Location
LODE CLAIM

Dated _____, 19____

Filed and Recorded at request of

R. W. Langworthy

Dec. 14 A. D. 19*17*

at _____ a. M.,

Book *R. P. Bond of mine*

Pages *399*

R. P. Bond
County Recorder.

By *L. M. Shihel*
Deputy Recorder.

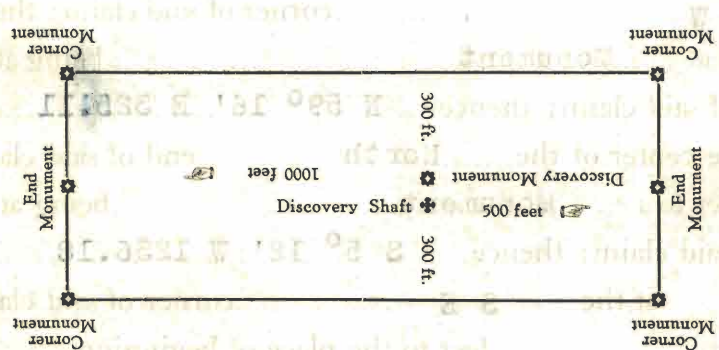

This Diagram is to give locator a general idea of plan of location under the new law. The Discovery Shaft can be in the center of the claim or any distance from either end desired. In the diagram it is placed 500 feet from one end and 1000 ft. from the other.

Commence description of claim at a center end monument, giving its distance and direction from center of Discovery Shaft; thence bound the claim in either direction. In description be careful to state locality of claim with reference to some natural object, or permanent monument, as will identify the claim.

STATE OF ARIZONA, }
COUNTY OF PIMA. } ss.

I, R.B. Vinson _____, County Recorder in and for the

County of Pima, State of Arizona, do hereby certify that the above and foregoing is a full, true and correct copy
of Amended Location Notice of the Apache Central Mining Claim sit-
uated in the Old Hat Mining District, and now owned by Daily-Con-
solidated Copper Company, dated Nov. 22nd, 1917.

as appears of record now in my office in Book B.B.B. Record of Mines Pages 380

IN WITNESS WHEREOF, I have hereunto set my hand
and affixed my official seal, at my office in Tucson,

this Eighth _____ day of

January _____, A. D. 1917

R.B. Vinson
County Recorder of Pima County, Arizona.

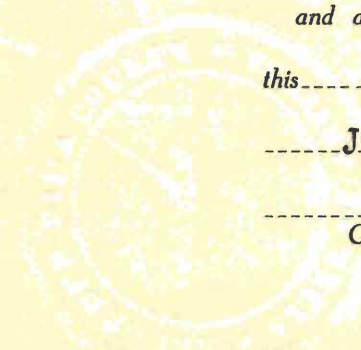

13

19

AMENDED

Notice of Mining Location

LODE CLAIM

TO ALL WHOM IT MAY CONCERN:

This Mining Claim, the name of which is the APACHE CENTRAL Mining Claim, situate on lands belonging to the United States of America, and in which there are valuable mineral deposits, was entered upon and located for the purpose of exploration and purchase by J W DAILY JR, a citizen of the United States grantor of

(Locator must insert either "a citizen of the United States." or "who has declared his intention to become a citizen of the United States.")

the undersigned, on the 25th day of April, 1914

The length of the claim is 1497.07 feet, and we claim 350 feet,

in a N 5° 12' E direction and 1147.07

feet in a S 5° 12' W direction from the center of the discovery shaft, at which this notice was posted, lengthwise of the claim, together with 300 feet in width of surface grounds, on each side of the center of said claim. The general course of the lode deposit and premises is from the

N 5° 12' E to the S 5° 12' W

The Claim is situated and located in the OLD HAT Mining District, in

Pima County in the State of Arizona, ~~ARIZONA~~

in a ~~direction~~ from S. W. Cor. Claim

N. W. Cor. Sec 21, T. 11 S., R. 16 E. bears N 43° 31' W 154.94

The surface boundaries of the claim are marked upon the ground as follows: Beginning at A Monument of Stone

at a point in a N 5° 12' W direction 350 feet from

the discovery shaft (at which this notice is posted), being in the center of the North

end line of said claim; thence N. 59° 16' E. 256.75 feet to a Monument

, being the N. E corner of said claim; thence

S 1° 50' W 1436.1 feet to a Monument, being at the

S. E corner of said claim; thence S 59° 16' W. 361.11 feet

to a Monument at the center of the South end of said claim;

thence S 59° 16' W 361.11 feet to a Monument being at the

S. W corner of said claim; thence N 5° 12' E 1497.07 feet

to a Monument at the N. W corner of said claim;

thence N 59° 16' E 361.11 feet to the place of beginning.

All done under the provisions of Chapter Six, of Title XXXII, of the Revised Statutes of the United States, and of an Act of the General Assembly of Arizona, entitled "An Act to Revise and Codify the Laws of the Territory of Arizona," approved March 16, 1901.

This is an Amended Location Notice of the APACHE CENTRAL

Mining Claim, located by J. W. Daily, Jr., a citizen of the United States

grantor of the undersigned owner on the 25th day of

April, 1914, and recorded in Book V. V of Records of Mines, at

page 424, in the office of the County Recorder of the aforesaid County of _____

to which reference is hereby made, and this amended Location Notice is made and posted to

correct errors in the description in the said original Location Notice.

Dated and posted on the ground this 22nd day of July, 1917

DAILY-ARIZONA CONSOLIDATED COPPER COMPANY,

(Present Owner)

By

J. Hancock
Its Attorney in Fact

STATE OF ARIZONA,

County of _____

ss.

I _____, County Recorder in and for the County and State aforesaid, do hereby certify that the within instrument was filed for record at _____ o'clock _____ M., on this _____ day of _____ 19____, and duly recorded in book No. _____ of _____ Records of _____ County, Arizona, at pages _____.

WITNESS my hand and official seal the year first above written.

Country Recorder.

AMENDED
Notice of Location
LODE CLAIM

Dated _____, 19____

Filed and Recorded at request of

R. W. Caspary

Dec. 14 A. D. 19*17*

at *11-30* a. M.,

Book *F. B. Beard of mine*

Pages *280*

By *P. B. Vissel*
County Recorder.
H. M. Hubel
Deputy Recorder.

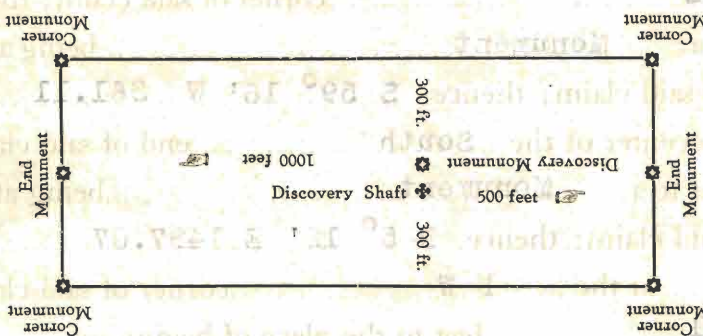

This Diagram is to give locator a general idea of plan of location under the new law. The Discovery Shaft can be in the center of the claim or any distance from either end desired. In the diagram it is placed 500 feet from one end and 1000 ft. from the other.

Commence description of claim at a center end monument, giving its distance and direction from center of Discovery Shaft; thence bound the claim in either direction. In description be careful to state locality of claim with reference to some natural object, or permanent monument, as will identify the claim.

STATE OF ARIZONA, }
COUNTY OF PIMA. } ss.

I, R. B. Vinson, County Recorder in and for the
County of Pima, State of Arizona, do hereby certify that the above and foregoing is a full, true and correct copy
of ~~Amended Location Notice of the Daily Tunnel Site Mining Claim~~
~~situated in the Old Hat Mining District, and now owned by the~~
~~Daily-Arizona Consolidated Copper Company, dated Nov. 22nd, 1917~~
as appears of record now in my office in Book B. B. B. Record of Mines Pages 381

IN WITNESS WHEREOF, I have hereunto set my hand
and affixed my official seal, at my office in Tucson,
this Eighth day of
January, A. D. 1917

R. B. Vinson
County Recorder of Pima County, Arizona.

14

33
22

AMENDED

Notice of Mining Location

LODE CLAIM

TO ALL WHOM IT MAY CONCERN:

This Mining Claim, the name of which is the **DAILY TUNNEL SITE** Mining Claim, situate on lands belonging to the United States of America, and in which there are valuable mineral deposits, was entered upon and located for the purpose of exploration and purchase by **J W DAILY, a citizen of the United States,** grantor of

(Locator must insert either "a citizen of the United States." or "who has declared his intention to become a citizen of the United States.")

the undersigned, on the **21st** day of **October**, 19**11**.

The length of the claim is **1500** feet, and **we** claim **700** feet, in a **S 59° 16' W** direction and **800** feet in a **N 59° 16' E** direction from the center of the discovery shaft, at which this notice was posted, lengthwise of the claim, together with **300** feet in width of surface grounds, on each side of the center of said claim. The general course of the lode deposit and premises is from the **S 59° 16' W** to the **N 59° 16' E**

The Claim is situated and located in the **OLD HAT** Mining District, in **Pima** County in the State of Arizona, ~~in~~ in a ~~direction~~ from **N.W. Cor. Claim**. The **N W Cor Section 21, T 11 S, R 16 E, bears N 43° 31' W 154.94**

The surface boundaries of the claim are marked upon the ground as follows: Beginning at **a Monument of Stone**

at a point in a **S 59° 16' W** direction **700** feet from the discovery shaft (at which this notice is posted), being in the center of the **West** end line of said claim; thence **N 5° 12' E 300** feet to a **Monument**, being the **N.W. Cor** corner of said claim; thence **N 59° 16' E 1500** feet to a **Monument**, being at the **N.E.** corner of said claim; thence **S 5° 12' W 300** feet to a **Monument** at the center of the **East** end of said claim; thence **S 5° 12' W 300** feet to a **Monument** being at the **S.E.** corner of said claim; thence **S 59° 16' W 1500** feet to a **Monument** at the **S.W.** corner of said claim; thence **N 5° 12' E 300** feet to the place of beginning.

All done under the provisions of Chapter Six, of Title XXXII, of the Revised Statutes of the United States, and of an Act of the General Assembly of Arizona, entitled "An Act to Revise and Codify the Laws of the Territory of Arizona," approved March 16, 1901.

This is an Amended Location Notice of the **TUNNEL SITE** Mining Claim, located by **J. W. Daily, Grantor of the undersigned owner,** on the **21st** day of **October**, 19**11**, and recorded in Book **S S** of Records of Mines, at page **4**, in the office of the County Recorder of the aforesaid County of **Pima** to which reference is hereby made, and this amended Location Notice is made and posted to correct errors in the description in the said original Location Notice.

Dated and posted on the ground this **22nd** day of **Nov**, 19**11**

DAILY-ARIZONA CONSOLIDATED COPPER COMPANY,
(Present Owner)

By

Blaircock
Its Attorney in Fact.

STATE OF ARIZONA,

County of _____

ss.

I _____, County Recorder in and for the County and State aforesaid, do hereby certify that the within instrument was filed for record at _____ o'clock _____ M., on this _____ day of _____ 19____, and duly recorded in book No. _____ of _____ Records of _____ County, Arizona, at pages _____

WITNESS my hand and official seal the year first above written.

Country Recorder.

AMENDED

Notice of Location

LODE CLAIM

Dated _____, 19____

Filed and Recorded at request of

P. W. Langworthy

Dec 14 A. D. 19____

at _____ a. M.,

Book *B. P. B. Record of Merrill*

Pages _____

County Recorder.

By *P. M. Shubert* Deputy Recorder.

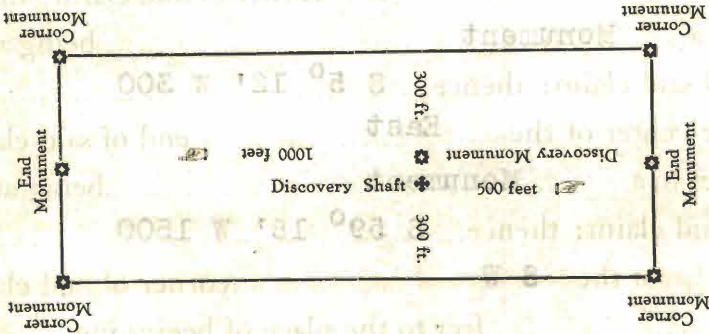

This Diagram is to give locator a general idea of plan of location under the new law. The Discovery Shaft can be in the center of the claim or any distance from either end desired. In the diagram it is placed 500 feet from one end and 1000 ft. from the other. Commence description of claim at a center end monument, giving its distance and direction from center of Discovery Shaft; thence bound the claim in either direction. In description be careful to state locality of claim with reference to some natural object, or permanent monument, as will identify the claim.

DAILY-ARIZONA CONSOLIDATED COPPER COMPANY.
(Incident Owner)

The Assessor in fact.

U. S. SURVEYOR-GENERAL'S FINAL CERTIFICATE ON FIELD NOTES.

Department of the Interior,

OFFICE OF U. S. SURVEYOR-GENERAL,

Phoenix, Arizona,

May 28, 1919

I, U. S. Surveyor-General for District of Arizona

do hereby certify that the foregoing transcript of the Field Notes, return and approval of the survey of the mining claim of

DAILY ARIZONA CONSOLIDATED COPPER COMPANY

known as the COPPER PRINCESS, APACHE CENTRAL AND DAILY TUNNEL SITE LODES. situate in OLD HAT

Mining District, PIMA County, ARIZONA.

in Section 21, uns. 16, 17, 20 Township No. 11 S., Range No. 16 E., and

designated as Survey No. 3500, has been correctly copied from the originals on file in this office; that said Field Notes furnish such an accurate description of said mining claim as will, if incorporated into a patent, serve fully to identify the premises, and that such reference is made therein to natural objects or permanent monuments as will perpetuate and fix the locus thereof.

And I further certify that five hundred dollars' worth of labor has been expended or improvements made upon each of said mining claims except the daily Tunnel Site, by claimant or its grantors, and that said improvements consist of 1 shaft, 14 cuts, 4 tunnels, 1 trench, 1 winze, 3 upraises and 1 drift, total value \$9960, \$5500 of which is reserved for the claims of Sur. No. 3499. Improvement No. 7 on the Copper Princess lode is a common improvement for the benefit and development of the Copper Princess lode of this survey and the 11 claims of Sur. No. 3499, and a 1/12 interest therein is properly credited to each of the said claims.

and that no portion of said labor or improvements has been included in the estimate of expenditures upon any other claim.

I further certify that the plat thereof, filed in the U. S. Land Office at Phoenix,

Arizona is correct and in conformity with the foregoing Field Notes.

Frank P. Trott,

United States Surveyor-General for Arizona.

SURVEYOR GENERAL'S CERTIFICATE OF APPROVAL OF FIELD NOTES AND SURVEY OF MINING CLAIM

DEPARTMENT OF THE INTERIOR OFFICE OF U. S. SURVEYOR GENERAL

Phoenix, Arizona,

May 28, 1919

I, U. S. Surveyor General for District of Arizona

do hereby certify that the foregoing and hereto attached Field Notes and Return of the Survey of the Mining Claim of

DAILY ARIZONA CONSOLIDATED COPPER COMPANY

, known as the

COPPER PRINCESS, APACHE CENTRAL AND DAILY TUNNEL SITE LODES.

situate in OLD HAT mining district,

PIMA County, ARIZONA.

in Sections 16, 17, 20, 21, uns Township No. 11 S., Range No. 16 E.

, designated as Survey No. 3500

executed by T. N. Stevens, U. S. Mineral

Surveyor, April 25-28, 1918, under my instructions dated

April 12, 1918, have been critically examined and the necessary cor-

rections and explanations made, and the said Field Notes and Return, and the Survey they describe,

are hereby approved. The certified copy of the location certificate filed by the applicant for survey is

on file in this office and a true copy of said certified copy of said location certificate is included and made

a part of the transcript of the field notes.

[Handwritten signature]

U. S. Surveyor General for Arizona.

(4-691.)

Certificate of U. S. Surveyor General

AS TO

EXPENDITURES REPORTED AFTER RETURN OF SURVEY OF MINING CLAIM.

I, U. S. Surveyor General for District of Arizona,
do hereby certify that Five Hundred Dollars' worth of labor has been expended or
improvements made by claimant or its grantors, ^{each of} upon the mining claims of
Daily Arizona Consolidated Copper Company

known as the Copper Princess, Apache Central and Daily Tunnel Site lodes
situate in Old Hat mining district,
Pima County, Arizona
21, Unsur.,
in Sections 16, 17, 20, Township No. 11 S, Range No. 16 E.;

that said improvements consist of , in addition to those reported at
time of survey, 1 tunnel on the Daily Tunnel Site lode,
value \$300.

, and that no portion of said labor or improvements has been
included in the estimate of expenditures upon any other claim. A copy of the report of
T. N. Stevens, U. S. ~~Deputy~~ Mineral Surveyor, dated
August 1, 1919, is hereto attached.



U. S. Surveyor General for Arizona

Office of U. S. Surveyor General,

Phoenix, Arizona,

August 5, 1919

MINERAL SURVEY NO 3500

SUPPLEMENTAL REPORT OF IMPROVEMENTS.

--oOo--

I hereby certify that the value of the labor performed and improvements made upon or for the benefit of the Daily Tunnel Site lode embraced in Mineral Survey No. 3500 by the claimant or his grantors is not less than \$500. and that said improvement, in addition to those which were reported at the time of making the survey consist of:-

A tunnel the mouth of which being the discovery point at the face of improvement No.1 Daily Tunnel Site lode, 4 x 6 ft. running N. 30 ft. to face.

Value \$300.

Dated Aug 1 1919

T.N. Stevens
U.S. Mineral Surveyor.

I, T.N. Stevens, U.S. Mineral Surveyor for the District of Arizona, first being duly sworn, depose and say that the above supplemental report is true and correct and that the improvement mentioned therein was made and completed prior to the date of the expiration of the publication of the notice of application for patent to the lands embraced within Mineral Survey No. 3500

T.N. Stevens
U.S. Mineral Surveyor.

State of Arizona)
) s s.
County of Pima)

Subscribed and sworn to by said T.N. Stevens before me,
a Notary Public in and for the County of Pima, State of Arizona, this
1st day of August 1919, A.D.

Commission Expires July 10, 1920

Isabel M. Lauder
Notary Public.