

Book "G"
(Subdivisions)

ECC-102

FIELD NOTES

OF THE SURVEY OF THE

COMPLETION OF THE

SUBDIVISION LINES OF TOWNSHIP 18 NORTH, RANGE 21 WEST,

Of the Gila and Salt River Base and Meridian,

In the State of Arizona.

EXECUTED BY

Guy H. Richardson,

In the capacity of U. S. Surveyor, under instructions dated January 4,, 1915,
issued by the United States Surveyor General to govern surveys included in
Group No. 43, which were approved by the Commissioner of the General Land
Office, January 22,, 1915.

Survey commenced March 22,, 1915.

Survey completed March 24,, 1915.

Executed under assignment
Instructions dated Jan. 31 1915.

2882

2882

1A

BOOK 2882 Book "G" Group 43

INDEX DIAGRAM.

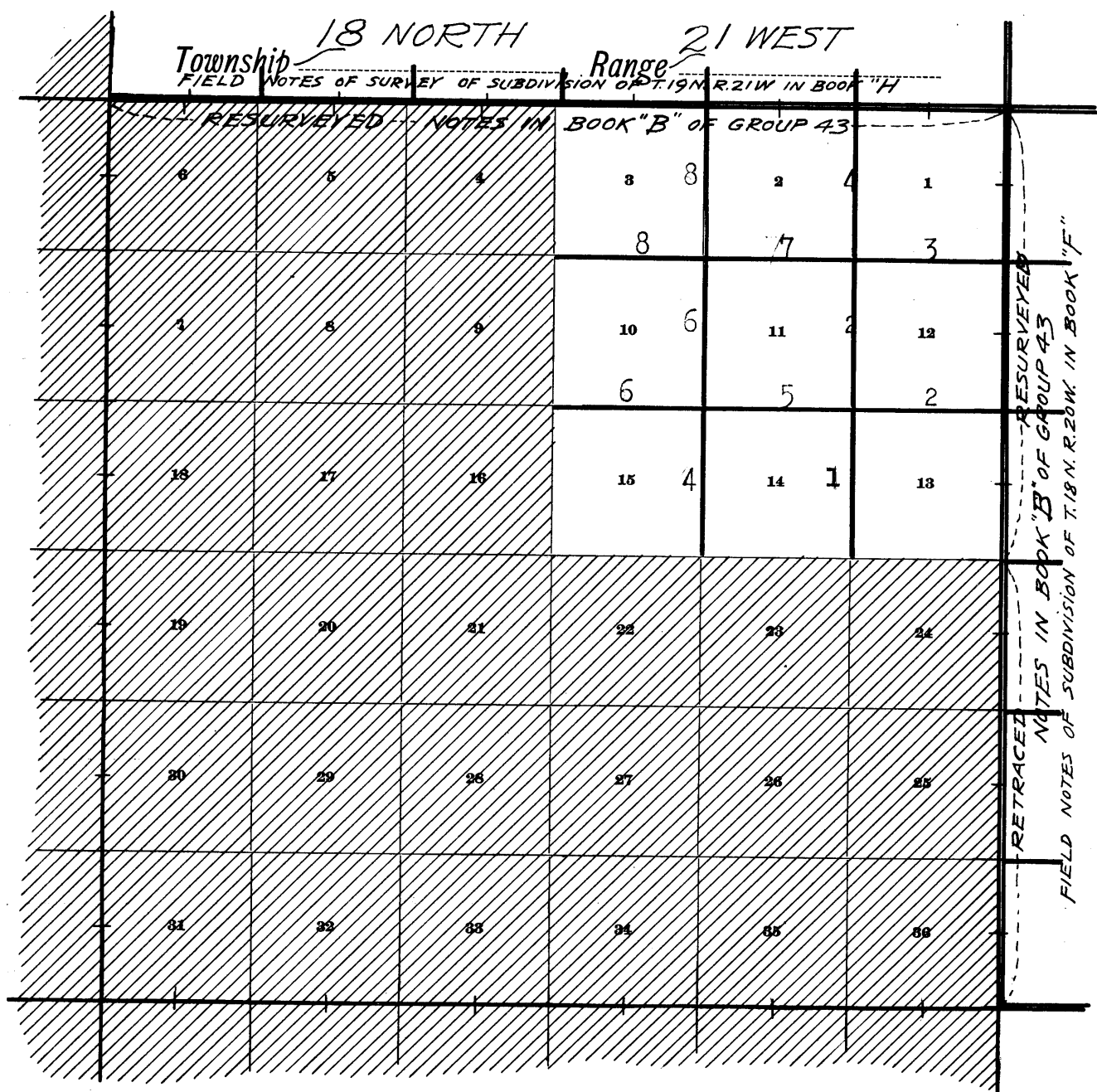

- Surveys described in field notes of Group 43
- Accepted surveyed lines.
- Shaded area surveyed as per plats on file.

Chains

Survey commenced Mar. 22, 1915, and executed by Guy H. Richardson, U. S. S., with a Young & Sons light mountain transit, No. 8484, with a Smith solar attachment.

For field test of instrument, see notes on subdivision of T. 18 N., R. 20 W. in Book "F."

Since run by Guy H. Richardson, U. S. S., Mar. 22, 1915.

1 section: At old cor. of secs. 13, 14, 23 and 24, which is a lava stone, 12 X 12 X 5 ins. above ground, marked and witnessed as described by the surveyor general, at 8h., 0m., a. m., l.m.t. I set off 0° 24' N. on the decl. arc, and 34° 56 $\frac{1}{2}$ ' on the lat. arc, and determine a meridian with the solar, thence I run N. 0° 1' W. bet. secs. 13 and 14. Over rolling land.

29.90 Wash, course W.

40.00 Set an iron post, 3 ft. long, 1 in. in diam., on surface rock, in a mound of stone, for 1/4 sec. cor., with a brass cap, marked

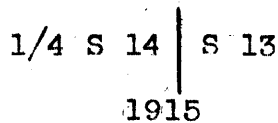

and raise a mound of stone, 2 ft. base, 1 $\frac{1}{2}$ ft. high, W. of cor.

Asc. gradually from 1/4 sec. cor.

60.85 Wagon road bet. Needles and Oatman, bears NE. and SW., 80 ft. above 1/4 sec. cor.

80.00 Set an iron post, 3 ft. long, 2 ins. in diam., on surface rock, in a mound of stone, for cor. of secs. 11, 12, 13 and 14, with a brass cap, marked

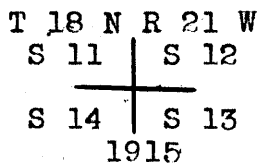

and raise a mound of stone, 2 ft. base, 1 $\frac{1}{2}$ ft. high, W. of cor.

Land rolling.

Soil, stony, 4th. rate.

Undergrowth, cactus and greasewood.

Completion of Subdivision of T. 18 N., R. 21 W.

Chains Mar. 22, 1915; at the cor. of secs. 11, 12, 13 and 14,
 at apparent noon, I set off $0^{\circ} 27'$ N. on the decl. arc,
 and observe the sun on the meridian, at noon, for lat.
 The resulting lat. is $34^{\circ} 57\frac{1}{2}'$ N.

S. $89^{\circ} 54'$ E. on a random line bet. secs. 12 and 13.

40.00 Set temp. $1/4$ sec. cor.

80.20 Intersect the E. bdy. of Tp. 2 lks. S. of reestablished
 cor. of secs. 7, 12, 13 and 18, described in Book "B1."

Thence I run

N. $89^{\circ} 55'$ W. on a true line bet. secs. 12 and 13.

Desc. over rolling land.

27.20 Wash, course SW., 120 ft. below sec. cor., thence
 over level land.

38.00 Road bet. Needles and Oatman, bears NE. and SW.

40.10 Set an iron post, 3 ft. long, 1 in. in diam., 26 ins. in
 the ground for $1/4$ sec. cor., with a brass cap, marked

$1/4$ S 12

S 13
 1915

and raise a mound of stone, 2 ft. base, $1\frac{1}{2}$ ft. high,
 N. of cor.

80.20 Cor. of secs. 11, 12, 13 and 14.

Land, rolling.

Soil, stony, 4th. rate.

Undergrowth, cactus and greasewood.

N. $0^{\circ} 1'$ W. bet. secs. 11 and 12.

Over level and rolling land, asc.

30.00 Wash, course SW., 50 ft. above sec. cor.

40.00 Set an iron post, 3 ft. long, 1 in. in diam., 26 ins. in
 the ground for $1/4$ sec. cor., with a brass cap, marked

$1/4$ S 11 | S 12

1915

and raise a mound of stone, 2 ft. base, $1\frac{1}{2}$ ft. high,
 W. of cor.

Thence over rolling land.

Chains

45.00 Wash, course W.

80.00 Set an iron post, 3 ft. long, 2 ins. in diam., 24 ins. in the ground for cor. of secs. 1, 2, 11 and 12, with a brass cap, marked

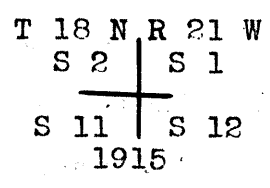

and raise a mound of stone, 2 ft. base, 1 1/2 ft. high, W. of cor.

Land, level and gently rolling.

Soil, stony, 4th. rate.

Undergrowth, cactus and greasewood.

S. 89° 55' E. on a random line bet. secs. 1 and 12.

40.00 Set temp. 1/4 sec. cor.

80.18 Intersect reestablished cor. of secs. 1, 6, 7 and 12 on E. bdy. of the township, described in Book "B."

Thence I run

N. 89° 55' W. on a true line bet. secs. 1 and 12.

Over rolling land.

10.18 Wash, course SW.

25.18 Wash, course SW.

40.09 Set an iron post, 3 ft. long, 1 in. in diam., 26 ins. in the ground for 1/4 sec. cor., with a brass cap, marked

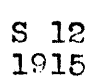
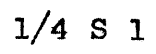

and raise a mound of stone, 2 ft. base, 1 1/2 ft. high, N. of cor.

80.18 Cor. of secs. 1, 2, 11 and 12.

Land rolling.

Soil, stony, 4th. rate.

Undergrowth, cactus and greasewood.

Chains N. 0° 1' W. on a random line bet. secs. 1 and 2.

40.00 Set temp. 1/4 sec. cor.

80.05 Intersect the N. bdy. of the township 3 lks. W. of reestablished cor. of secs. 1, 2, 35 and 36, described in Book "B."
Thence I run
South on a true line bet. secs. 1 and 2.
Over gently rolling land.

40.05 Set an iron post, 3 ft. long, 1 in. in diam., 26 ins. in the ground for 1/4 sec. cor., with a brass cap, marked

$$\begin{array}{c} 1/4 \text{ S } 2 \quad | \quad \text{S } 1 \\ 1915 \end{array}$$
and raise a mound of stone, 2 ft. base, 1 1/2 ft. high, W. of cor.

78.00 Wash, course SW.

80.05 Cor. of secs. 1, 2, 11 and 12.
Land, gently rolling.
Soil, stony, 4th. rate.
Undergrowth, greasewood.

March 22, 1915.

March 23, 1915; At old cor. of secs. 14, 15, 22 and 23, which is a lava stone 12 X 9 X 6 ins. above ground, marked and witnessed as described by the surveyor general, At 9h. 0m., a. m., l.m.t. I set off 0° 48' N. on the decl. arc, 34° 56 1/2' on the lat. arc, and determine a meridian with the solar.

Thence I run
N. 0° 1' W. bet. secs. 14 and 15.
Over rolling land, asc.

3.30 Road bet. Needles and Oatman, bears E. and W., thence over gently rolling land.

40.00 Set an iron post, 3 ft. long, 1 in. in diam., 26 ins. in the ground for 1/4 sec. cor., with a brass cap, marked

$$\begin{array}{c} 1/4 \text{ S } 15 \quad | \quad \text{S } 14 \\ 1915 \end{array}$$
and raise a mound of stone, 2 ft. base, 1 1/2 ft. high,

Chains W. of cor.
 50.00 Wash, course W.
 71.90 Wash, course W.
 80.00 Set an iron post, 3 ft. long, 2 ins. in diam., on surface rock, in a mound of stone, for cor. of secs. 10, 11, 14 and 15, with a brass cap, marked

T 18 N	R 21 W
S 10	S 11
S 15	S 14
1915	

and raise a mound of stone, 2 ft. base, $1\frac{1}{2}$ ft. high, W. of cor.
 Land rolling.
 Soil, stony, 4th. rate.
 Undergrowth, greasewood.

N. 89° 56' E. on a random line bet. secs. 11 and 14.
 40.00 Set temp. $1/4$ sec. cor.
 80.00 Intersect N. and S. line 23 lks. S. of the cor. of secs. 11, 12, 13 and 14, thence I run
 S. 89° 46' W. on a true line bet. secs. 11 and 14.
 Over rolling land.
 35.00 Wash, course SW.
 40.00 Set an iron post, 3 ft. long, 1 in. in diam., 26 ins. in the ground for $1/4$ sec. cor., with a brass cap, marked

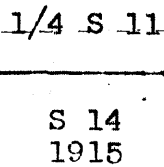

and raise a mound of stone, 2 ft. base, $1\frac{1}{2}$ ft. high, N. of cor.
 68.00 Wash, course SW.
 80.00 Cor. of secs. 10, 11, 14 and 15.
 Land, slightly rolling.
 Soil, stony, 4th. rate.
 Undergrowth, cactus and greasewood.

Chains N. 89° 54' W. on a random line bet. secs. 10 and 15.

40.00 Set temp. 1/4 sec. cor.

80.20 Intersect N. and S. line 14 lks. S. of old cor. of secs. 9, 10, 15 and 16, which is a lava stone, 10 X 10 X 6 ins. above ground, marked and witnessed as described by the surveyor general.

Thence I run

S. 89° 48' E. on a true line bet. secs. 10 and 15.

Over level land.

34.10 Wash, 2 chs. wide, 15 ft. deep, course SW.

40.10 Set an iron post, 3 ft. long, 1 in. in diam., on surface rock, in a mound of stone for 1/4 sec. cor., with a brass cap, marked

1/4 S 10

S 15
1915

and raise a mound of stone, 2 ft. base, 1 1/2 ft. high, N. of cor.

60.20 Dim road, bears NE. and SW.

80.20 Cor. of secs. 10, 11, 14 and 15.

Land, level.

Soil, stony, 4th. rate.

Undergrowth, cactus and greasewood.

N. 0° 1' W. bet. secs. 10 and 11.

Over level land.

22.00 Wash, course SW.

40.00 Set an iron post, 3 ft. long, 1 in. in diam., on surface rock, in a mound of stone, for 1/4 sec. cor., with a brass cap, marked

1/4 S 10 | S 11
1915

and raise a mound of stone, 2 ft. base, 1 1/2 ft. high, W. of cor. Thence over rolling land.

80.00 Set an iron post, 3 ft. long, 2 ins. in dia., on surface

Completion of Subdivision of ~~Secs.~~ T. 18 N., R. 21 W.

Chains

rock, in a mound of stone, for cor. of secs. 2, 3, 10 and 11, with a brass cap, marked

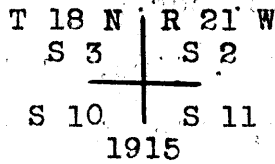

and raise a mound of stone, 2 ft. base, $1\frac{1}{2}$ ft. high, W. of cor.

Land, level and slightly rolling.

Soil, stony, 4th. rate.

Undergrowth, greasewood.

N. $89^{\circ} 46'$ E. on a random line bet. secs. 2 and 11.

40.00 Set temp. $\frac{1}{4}$ sec. cor.

79.94 Intersect N. and S. line 7 lks. S. of the cor. of secs.

1, 2, 11 and 12, thence I run

S. $89^{\circ} 43'$ W. on a true line bet. secs. 2 and 11.

Over level land.

4.95 Draw, course SW., desc. gradually over rolling land.

39.97 Set an iron post, 3 ft. long, 1 in. in dia., on surface

rock, in a mound of stone, for $\frac{1}{4}$ sec. cor., with a brass cap, marked

$\frac{1}{4}$ S 2

S 11
1915

and raise a mound of stone, 2 ft. base, $1\frac{1}{2}$ ft. high,

N. of cor. Thence over level land.

79.94 Cor. of secs. 2, 3, 10 and 11.

Land, level and rolling.

Soil, stony, 4th. rate.

Undergrowth, greasewood.

March 23, 1915.

March 24, 1915; At the cor. of secs. 2, 3, 10 and 11, at 3h., 0m., p. m., l. m. t., set off $1^{\circ} 17\frac{1}{2}'$ N. on the decl. arc, and $34^{\circ} 58'$ on the lat. arc, and determine a meridian with the solar,

Chains	Thence I run
	N. 89° 48' W. on a random line bet. secs. 3 and 10.
40.00	Set temp. 1/4 sec. cor.
80.60	Intersect N. and S. line, 21 lks. S. of old cor. of secs. 3, 4, 9 and 10, which is a lava stone, 30 X 12 X 10 ins, set in a mound of stone, and marked and witnessed as described by the surveyor general.
	Thence I run
	S. 89° 39' E. on a true line bet. secs. 3 and 10.
	Over level land.
40.60	Set an iron post, 3 ft. long, 1 in. in diam., 26 ins. in the ground for 1/4 sec. cor., with a brass cap, marked
	1/4 S 3
	S 10 1915
	and raise a mound of stone, 2 ft. base, 1 1/2 ft. high, N. of cor.
73.40	Draw, course SW.
80.60	Cor. of secs. 2, 3, 10 and 11.
	Land, level.
	Soil, stony, 4th. rate.
	Undergrowth, cactus and greasewood.
	N. 0° 1' W. on a random line bet. secs. 2 and 3.
40.00	Set temp. 1/4 sec. cor.
80.60	Intersect the N. bdy. of the Tp. 16 lks. E. of reestablished cor. of secs. 2, 3, 34 and 35, described in Book "B."
	Thence I run
	S. 0° 8' E. on a true line bet. secs. 2 and 3.
	Over level land.
6.50	Draw, course W.
40.60	Set an iron post, 3 ft. long, 1 in. in diam., 26 ins. in the ground for 1/4 sec. cor., with a brass cap, marked
	1/4 S 3 S 2 1915
	and raise a mound of stone, 2 ft. base, 1 1/2 ft. high,

Completion of Subdivision of T. 18 N., R. 21 W.

Chains W. of cor.
 58.00 Wash, course W.
 80.60 Cor. of secs. 2, 3, 10 and 11.
 Land, level.
 Soil, stony, 4th. rate.
 Undergrowth, greasewood.

March 24, 1915.
 Guy H. Richardson, U.S.S.

Boundaries of NE. $\frac{1}{4}$ of T. 18 N., R. 21 W.
 Latitudes, departures and closing errors.

Line designated	True Bearing	Distance	Latitudes		Departures	
			N	S	E	W
Subdivisional	N. 89° 54' W.	80.00	0.14			80.00
S. boundary.	S. 89° 56' W.	80.06		0.09		80.06
S. bdy. sec. 10	N. 89° 54' W.	79.98	0.14			79.98
E. bdy. sec. 10, 15	N. 0° 2' W.	160.00	160.00			0.09
W. bdy. sec. 3.	N. 0° 4' W.	79.89	79.89			0.09
North. bdy. of Tp.	S. 89° 55' E.	240.75		0.35	240.75	
East. bdy. of Tp.	South	240.00		240.00		
Convergency					0.11	
Totals			240.17	240.44	240.86	240.22
Error in lat				240.17		
				0.27		
Error in dep.					240.22	
					0.64	

GENERAL DESCRIPTION.

This township is rolling land throughout and the drainage is in a SW. direction, by numerous deep cut washes. There is no timber or water in the NE. $\frac{1}{4}$, and no settlers. The undergrowth is cactus and greasewood and some scattering grass suitable for grazing. The land is generally covered with lava rock, and the soil is of low grade.

March 24, 1915.

G. H. Surveyor.

CERTIFICATE
FOR ~~FINAL OATH~~ OF UNITED STATES SURVEYOR:
see book "C" of this group.

I, _____, U. S. Surveyor, do solemnly swear that, in pursuance of special instructions received from the U. S. Surveyor General for _____ bearing date of the _____ day of _____, 191____, I have well, faithfully, and truly, in my own proper person, and in strict conformity with said instructions, the Manual of Surveying Instructions, and the laws of the United States, surveyed all those parts or portions of _____ of the _____ Meridian, in the State of _____, which are represented in the foregoing field notes as having been executed by me, and under my direction; and I do further solemnly swear that all the corners of said survey have been established and perpetuated in strict accordance with the Manual of Surveying Instructions, and the special written instructions of the U. S. Surveyor General for _____ and in the specific manner described in the field notes, and that the foregoing are the original field notes of such survey.

U. S. Surveyor.

Subscribed by said _____, and sworn to before me }
this _____ day of _____, 191____



APPROVAL.

OFFICE OF THE UNITED STATES SURVEYOR GENERAL,

Phoenix, Arizona, *February 26*, 1917.

The foregoing field notes of the survey of _____ the Completion of the

Subdivision Lines of

TOWNSHIP 18 NORTH, RANGE 21 WEST,

of the Gila and Salt River Base and Meridian, in the State of
Arizona,

executed by Guy H. Richardson, U. S. Surveyor,

under his special instructions dated January 4, 1915, for group 43., having been critically examined, and the necessary corrections and explanations made, the said field notes, and the surveys they describe, are hereby approved.

U. S. Surveyor General.
of Arizona.

~~I certify that the foregoing transcript of the field notes of the above described surveys in~~

~~_____ has been correctly copied from the original notes on file in this office.~~