

3395

Book "E"
4-679

BOOK 3395

FIELD NOTES

OF THE SURVEY OF THE

Boundaries of

ADDITION TO SUPERIOR TOWNSITE,

situate in Sec. 35 of

TOWNSHIP 1 SOUTH, RANGE 12 EAST,

Of the Gila and Salt River Base and Meridian,

In the State of Arizona.

EXECUTED BY

Sidney E. Blout.

In the capacity of U. S. Surveyor..., under Special Instructions dated May 12, 1917,
issued by the United States Surveyor General to govern surveys included in Group
No. 71, which were approved by the Commissioner of the General Land
Office, May 25, 1917, and Assignment Instructions dated June 12, 1917.

Survey commenced June 14, 1917

Survey completed June 18, 1917.

3395

3395

3395

SEE SPECIAL INDEX DIAGRAM.

INDEX DIAGRAM.

Township Range

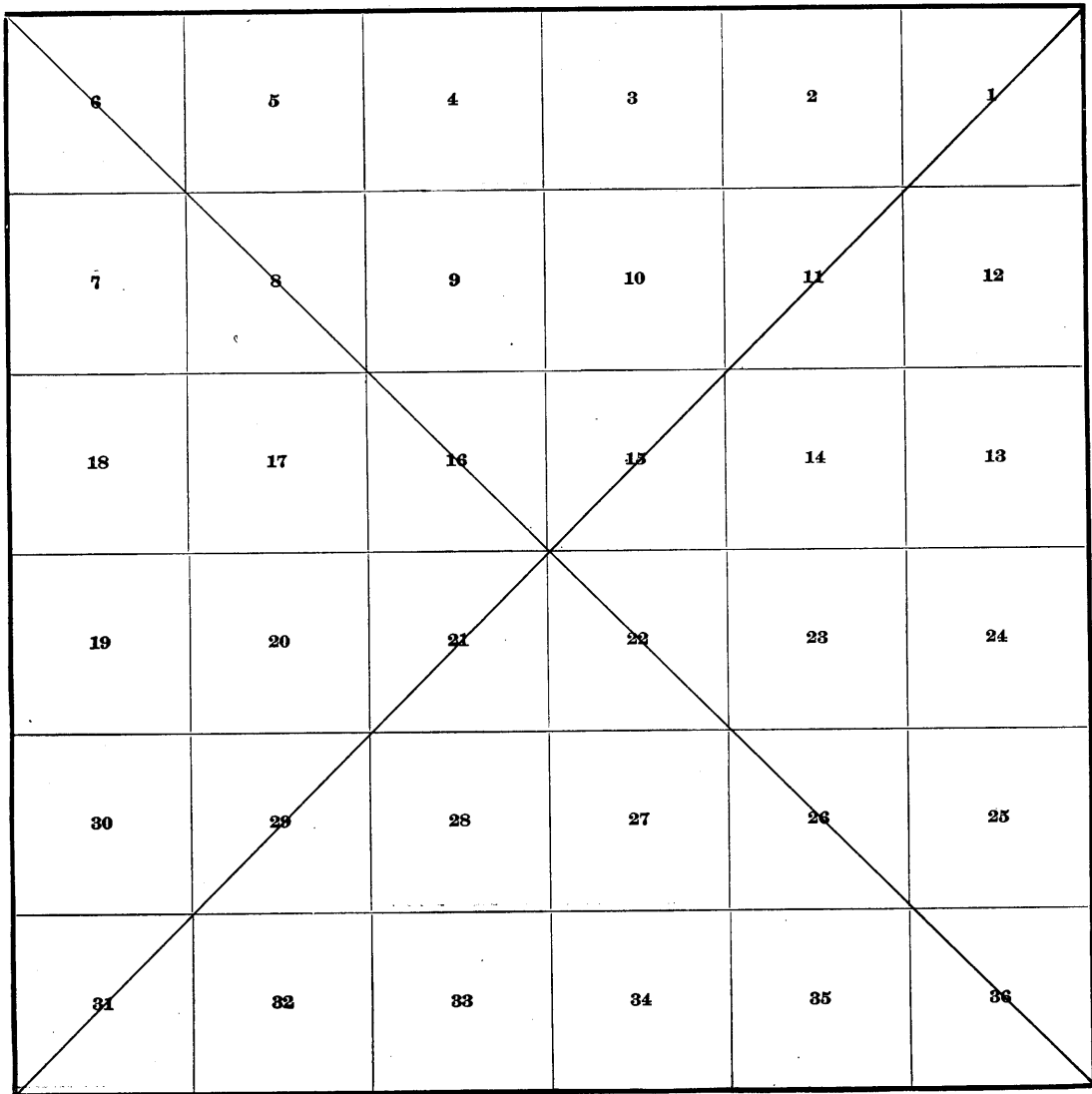

SPECIAL INDEX DIAGRAM.

3395

BOOK 3395

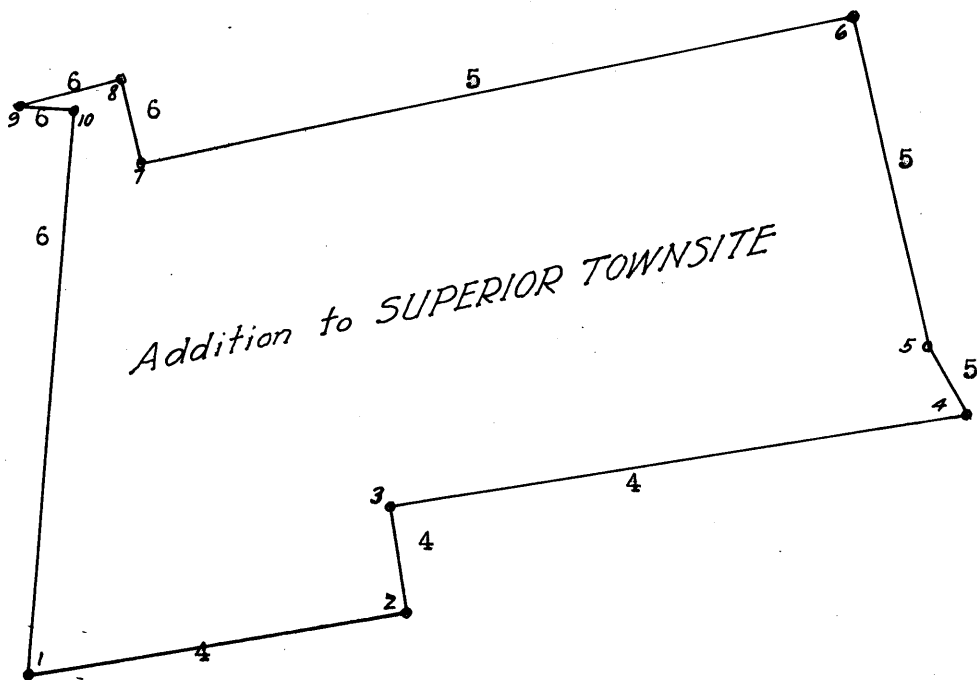

BOOK 3395

DATE DIAGRAM

Addition to Superior Townsite

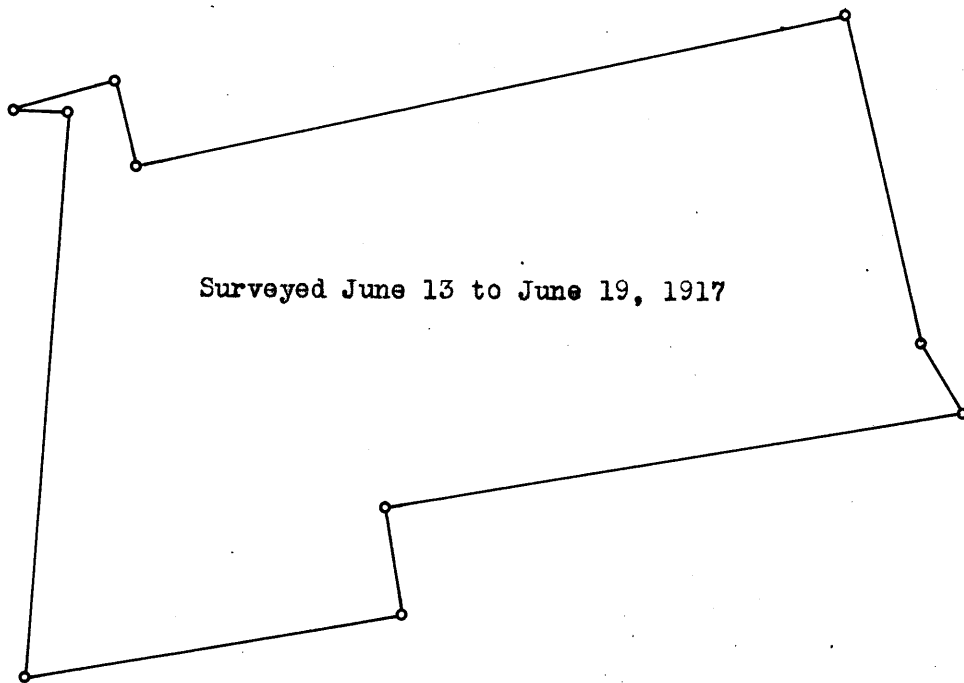

Addition to the Superior Townsite.

Chians

Survey commenced June 14, 1917 and executed with a Bull light mountain solar transit No. 9984 with solar attachment. The horizontal limb is provided with two double verniers, placed opposite to each other reading to single minutes of arc, which is also the least count of the verniers of the latitude and declination arcs.

The instrument was examined, tested on the Federal building meridian at Phoenix Arizona found correct, and was approved by the Assistant Supervisor of Surveys of the district of Arizona June 13, 1917.

Preliminary to beginning the survey of this townsite I examine the adjustments of the transit and correct all level and collimation errors; then, to test the solar apparatus, by comparing its indications, resulting from solar observations, made during a.m., and p.m. hours with a meridian established by observations on Polaris I proceed as follows; June 14, 1917. At the post, set to mark the north end center of the Windsor Lode claim, Lot No. 37 which is located in sec. 35 T1S., R12E. latitude 33° 17' N. longitude 111° 06' 10" W. I set off 33° 17' N. on the lat. arc, 23° 18' N. on the decl. arc and at 4^h 30^m p.m. determine a meridian with the solar and mark a point thereof by a tack driven in a stake set in the ground about 5.00 chs. N. of my instrument.

At 7^h 27^m p.m. l.m.t. by my watch which is correct local mean time I observe Polaris in accordance with instructions in the Manual and mark the direction thus determined by a tack driven in a stake set in the ground about 5.00 chs. N. of my instrument.

U.C. Polaris June 14, 1917 for meridian of Greenwich civil date and mean time.	8 ^h 01.8 ^m a.m.
Reduction to local meridian (subtract)	1.2 ^m
Time U.C. Polaris June 14 local Mer.	8 ^h 00.6 ^m a.m.

Time of observation June 14	7 ^h 27 ^m p.m.
Subtract time of U.C. Polaris	8 ^h 00.6 ^m a.m.
Hour angle of Polaris at Obs.	11 ^h 26.4 ^m
Azimuth of Polaris at Obs.	0° 11' W

June 14, 1917.

June 15, 1917. At 7^h 30^m a.m. I lay off the azimuth of Polaris 0° 11' to the east and mark the meridian thus determined by a tack driven in the stake set last evening on which the meridian falls .2 ins. east of the mark determined by the solar.

At 8^h 00^m a.m., l.m.t. I set off 33° 17' N on the lat. arc, 23° 19' N on the decl. arc and determine a meridian with the solar and mark a point thereof by a tack driven in the stake already set about 5.00 chs. N. of my instrument.; This point falls .4 ins east of the meridian established by the Polaris observation.

The solar apparatus by p.m. and a.m. observations defines positions for meridian respectively about 0° 11' west and 0° 21' east of the meridian established by the Polaris observation. therefore, I conclude that the adjustments of the instrument are satisfactory.

Preparatory to commencing the survey of this addition to the Townsite of Superior, I make a preliminary examination of the town site boundaries in the field for the purpose of familiarizing myself with the location of the governing lines and corners as defined by monuments on the ground. and find from this examination that there are no monuments on the ground to mark either the southwest corner of the addition, designated as cor. No. 1, or the cor., shown on the

Addition to the Superior Townsite

4

- Chains sketch plat as being located on the west boundary of the Superior Townsite; therefore, since that portion of the boundary of the townsite addition between the missing corners is not controlled by adjoining mining claims and since it appears to be the intent of the application to place the southwest corner of the townsite addition on the east boundary of the Ispeming Lode claim and the other missing cor. on the west boundary of the Superior Townsite, I determine the locus of these points as follows:
 June 15, 1917. At 8^h 30^m a.m., l.m.t. I set off 33° 17' N. on the lat. arc, 23° 19' N. on the decl. arc, and determine a meridian with the solar at the NW. cor. of the Superior Townsite, which is an iron post 1 in. in diam. 8 ins. above ground, firmly set, marked as described in the original field notes.
- Thence
 S 10° 11' E. on W. bdy. of the Superior Townsite.
- 3.35 Set a stake for temporary cor. No. 2 of the townsite addition
 Thence
 S 79.51' W on a random line
- 12.12 Intersect the east boundary of the Ispeming mineral lode claim (unsurveyed) at a point whence the northeast cor. of said claim, as defined by the NE. and SE. claim cor. monuments bears N 4° 30' E. 17.56 chs. dist.
 At the point of intersection, Set an iron post 3 ft. long 1 in. in diam. 30 ins. in the ground for cor. No. 1 of the Addition to the Townsite of Superior., marked on brass cap
- A.S.T. 1
- 1917
- From this point the $\frac{1}{4}$ sec. cor. on the S. bdy. of sec. 35 T1S., R12E., bears S 6° 38' E. 13.03 chs. dist.
 Thence I proceed with the survey of the townsite addition beginning at cor. No. 1
 Thence
 N 79 51' E. on true line along the line 1-2 of the addition
- 12.12 Intersect the stake set on the west boundary of the Superior Townsite for temp. cor. No. 2 of the townsite addition; I remove the stake and in the same place, Set an iron post 3 ft. long 1 in. in diam. 30 ins. in the ground for cor. No. 2 of the Addition to the Townsite of Superior, marked on brass cap
- AST 2
- 1917
- Thence
 N 10° 11' W along the west boundary of the Superior Townsite and line 2-3 of the townsite addition.
- 3.35 Intersect the NW. cor. of the Superior Townsite previously described. I mark this post on brass cap for cor. No. 3 of the Addition to the Superior Townsite.
- AST 3
- Thence
 N 79 50' E along the north boundary of the Superior Townsite and line 3-4 of the townsite addition.
- 10.23 Intersect the line 2-3 of the Security, patented mineral lode claim, Survey No. 2860 at a point whence cor. No. 3 of said claim bears N 23° 19' W 9.55 chs. dist.
- 16.26 Intersect the line 2-3 of the Wedge patented mineral lode claim Survey No. 2860 at a point whence cor. No. 3 of said claim bears N 26° 34' W 2.03 chs. dist.
- 18.26 Intersect cor. No. 4 of the Superior Townsite on the west

Addition to the Superior Townsite

Chains on the west boundary of the Windsor lode claim Lot No.37 which is an iron post 1 in.in diam, 8 ins.above ground, firmly set, marked and witnessed as described by the surveyor general.; I mark this post on brass cap for cor. No.4 of the Addition to the Townsite of Superior

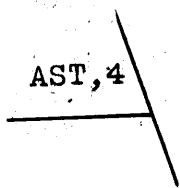

2.35 Thence N 30°55'W.along the west boundary of the Windsor lode claim Lot No.37 and line 4-5 of the townsite addition. Intersect the NW.cor.of the Windsor lode claim Lot No.37 which is identical with cor.No.2 of the Safety lode, cor. No.5 of the Security lode, and the N.E.C.of the Wedge lode claims, Survey No.2860, which is a pine post 4 ins.sq.24 ins.above ground, surrounded by a mound of stone and cement. Along north side of this post, Set an iron post 3 ft.long 1 in.in diam.12 ins.in the ground surrounded by a mound of stone 1 1/2 ft.base 1 ft.high laid in cement, for cor.No.5 of the Addition to the Superior Townsite., marked on brass cap

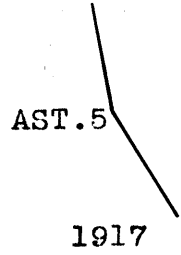

5.73 Thence N 14°06'W.along the line 2-3 of the Safety lode, identical with line 4-5 of the Security lode, Survey No.2860 and line 5-6 of the townsite addition. 10.41 Intersect cor.No.4 of the Security lode Survey No.2860. Intersect the southeast cor.of the Jack Rabbit lode claim (unsurveyed), which is a pine post 4 ins.sq.18 ins.above ground, set in a concrete base 1 ft.sq.8 ins.high.; Along east side of this post set an iron post 3 ft.long 1 in.in diam.12 ins.in the ground, surrounded by a concrete base 1 1/2 ft.sq.8 ins.high for cor.No.6 of the Addition to the Superior Townsite., marked on brass cap

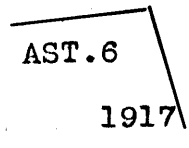

22.76 Thence S 77°18'W.along the south boundary of the Jack Rabbit lode claim and line 6-7 of the townsite addition. Intersect the southwest cor.of the Jack Rabbit lode claim which is a pine post 4 ins.sq.24 ins.above ground set in a concrete base 2 ft.sq.1 ft.high. Along the east side of this post, Set an iron post 3 ft.long 1 in.in diam.12 ins.in the ground, surrounded by a concrete base 2 ft.sq.12 ins. high for cor.No.7 of the Addition to the Superior Townsite marked on brass cap

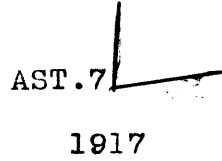

6 Chains

Addition to the Superior Townsite.

Thence

N 14°10'W. along the west boundary of the Jack Rabbit lode claim and line 7-8 of the townsite addition.

- 2.64 Intersect cor. No. 4 of the Monarch Mill Site, Survey No. 3144 which is a pine post 4 ins. sq. 24 ins. above ground surrounded by a mound of stone 2 ft. base 1 ft. high. Along the east side of this post; set an iron post 3 ft. long 1 in. in diam. 18 ins. in the ground, surrounded by a concrete base 2 ft. sq. 1 ft. high for cor. No. 8 of the Addition to the Superior Townsite., marked on brass cap

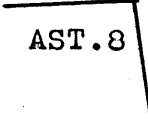
 AST. 8

1917

Thence

S 76°03'W. along the line 1-4 of the Monarch Mill Site, Survey No. 3144 and line 8-9 of the townsite addition

- 3.13 Intersect the north side line of the Ispeming lode claim (unsurveyed) at a point whence the northeast cor. of said claim bears S 87°06'E. 168 lks. dist.; At the point of intersection, which falls on a solid limestone ledge I drill a hole 1 1/4 ins. in diam. 12 ins. deep and set an iron post 14 ins. long 1 in. in diam., with neat portland cement 12 ins. in the hole for cor. No. 9 of the Addition to the Superior Townsite., marked on brass cap



 AST. 9

1917

Thence

S 87°06'E. along the north boundary of the Ispeming lode claim and line 9-10 of the townsite addition.

- 1.68 Intersect the northeast cor. of the Ispeming lode claim which is a pine post 4 ins. sq. 2 ft. above ground, surrounded by a concrete base 1 1/2 ft. sq. 8 ins. high.; Alongside of this post to the north; Set an iron post 3 ft. long 1 in. in diam. 18 ins. in the ground, surrounded by a concrete base 2 ft. sq. 1 ft. high for cor. No. 10 of the Addition to the Superior Townsite., marked on brass cap



 AST. 10

1917

Thence

S 4°30'W. along the east boundary of the Ispeming lode claim (unsurveyed), and line 1-10 of the addition to the Superior Townsite.

- 17.56 To cor. No. 1 of the Addition to the Townsite of Superior the place of beginning.

 U.S. Surveyor.

Boundaries of Addition to Superior Townsite, Arizona.

Latitudes, Departures, and Closing Errors.

Line.	Bearing.	Distance.	Latitudes.		Departures.	
			N.	S.	E.	W.
1-2	N.79° 51'E.	12.12	2.14		11.93	
2-3	N.10° 11'W.	3.35	3.30			.59
3-4	N.79°50'E.	18.26	3.22		17.97	
4-5	N.39°55'W.	2.35	2.02			1.21
5-6	N.14°06'W.	10.41	10.10			2.54
6-7	S.77°18'W.	22.76		5.00		22.20
7-8	N.14°10'W.	2.64	2.56			.65
8-9	S.76°03'W.	3.13		.75		3.04
9-10	S.87°06'E.	1.68		.08	1.68	
10-1	S.4° 30'W.	17.56		17.51		1.38
Totals,			23.34	23.34	31.58	31.61
				23.34		31.58
Error in latitude,				0.00		
Error in departure,						0.03

BOOK 3395
10

CERTIFICATE OF UNITED STATES SURVEYOR.

I, Sidney E. Blout, U. S. Surveyor, hereby certify upon honor that, in pursuance of special instructions received from the U. S. Surveyor General, for Group No. 71, Arizona, bearing date of the 12th day of May, 1917, I have well, faithfully, and truly in my own proper person, and in strict conformity with said instructions, the Manual of Surveying Instructions, and the laws of the United States, surveyed all those parts or portions of the Boundaries of

ADDITION TO SUPERIOR TOWNSITE,

situate in Sec. 35 of

TOWNSHIP 1 SOUTH, RANGE 12 EAST,

of the Gila and Salt River Base and Meridian, in the State of Arizona, which are represented in the foregoing field notes and by diagram on page 1 hereof as having been executed by me, and under my direction; and that all the corners of said survey have been established and perpetuated in strict accordance with the Manual of Surveying Instructions, and the special written instructions of the U. S. Surveyor General, for Group 71, Arizona, and in the specific manner described in the field notes, and that the foregoing are the original field notes of such survey.

*Phoenix, Arizona
July 21, 1917.*

Sidney E. Blout
U. S. Surveyor.

APPROVAL.

OFFICE OF THE UNITED STATES SURVEYOR GENERAL,

Phoenix, Arizona, February 7, 1921.

The foregoing field notes of the survey of

*the Boundaries of
Addition to Superior Townsite
situate in*

*Sec. 35, Township 1 South - Range 12 East
of the Gila and Salt River Base and Meridian, in the State
of Arizona*

executed by *Sidney E. Blout, U.S. Surveyor*

under special instructions dated *May 12, 1917 For Group 71 Arizona*, having been critically examined, and the necessary corrections and explanations made, the said field notes, and the surveys they describe, are hereby approved.

Frank B. Frost
U. S. Surveyor General.

~~I certify that the foregoing transcript of the field notes of the above described surveys in~~
~~has been correctly copied from the original notes on file in this office.~~

~~U. S. Surveyor General.~~