

4002

Original

73

(1)

4-679

Book E.

BOOK 4002

FIELD NOTES

of the

metes-and-bounds survey of a body of

land classified as mineral bearing, included

within the Richmond Mining Claim, in

Section 8,

Township 1 South, Range 3 East,

Of the Gila and Salt River Meridian,

In the State of Arizona

EXECUTED BY

Francis E. Joy, U. S. Cadastral Engineer.

In the capacity of U. S. Surveyor, under Special Instructions dated April 5, 1932, issued by the District Cadastral Engineer to govern surveys included in Group No. 176, which were approved by the Commissioner of the General Land Office, April 20, 1932, and Assignment Instructions dated November 29, 1932.

Survey commenced February 3, 1933

Survey completed February 6, 1933.

4002

4002

INDEX DIAGRAM.

Township -----, Range -----

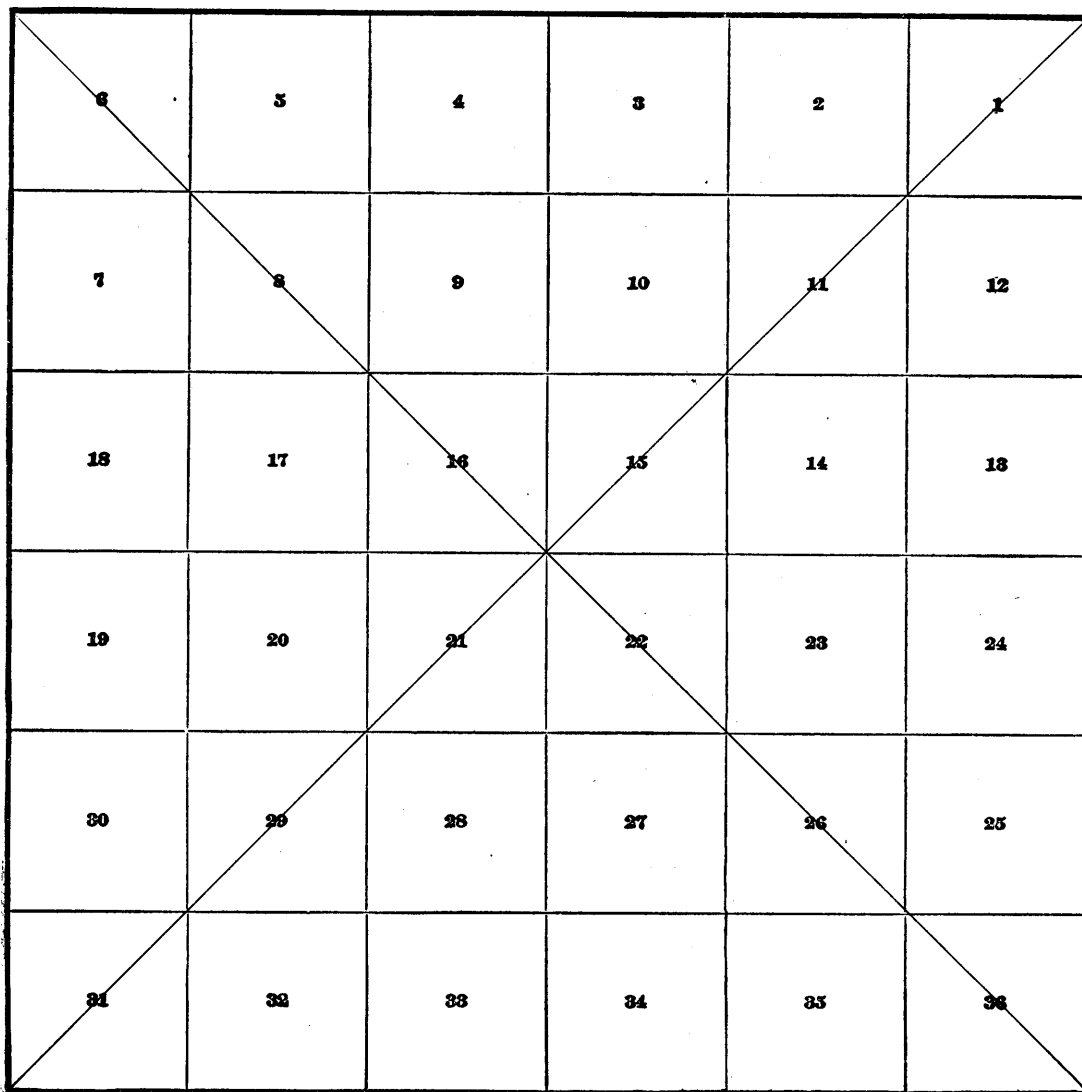

INDEX DIAGRAM

T. 1 S., R. 3 E.

BOOK 4002

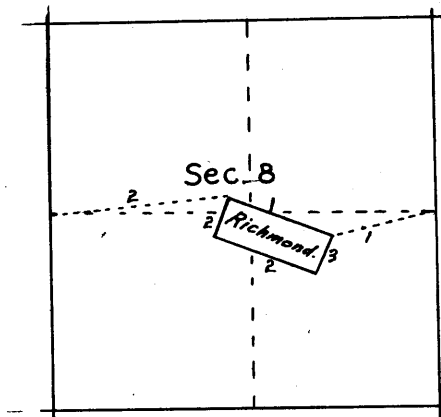

Chains.

The survey of the Richmond mining claim in sec. 8, T. 1 S., R. 3 E., Gila and Salt River Meridian was executed with a light mountain transit made by Buff & Buff. Serial No. 16723, with Smith solar attachment. For detailed description of instrument, equipment, and preliminary test of the solar attachment, see the field notes for T. 1 S., R. 2 E. of this group.

SURVEY OF THE RICHMOND.

Metes and bounds survey of a body of land known as the Richmond, located by George and Edward McClarty January 1 1920, classified as mineral bearing but not covered by mineral patent survey.

The boundaries of sec. 8 were surveyed or resurveyed as necessary by Sidney E. Blout, U. S. Cadastral Engineer during 1922, and are shown on plat approved Nov. 2, 1923,

Mrs. Nora McClarty, present claimant, pointed out the discovery monument and the SE. and NE. location monuments. The remainder of the location monuments have been destroyed. From the points available the bearing of the lode line is determined and the side lines run parallel thereto.

Beginning at the NE. location corner which is a mound of stone, 4 ft. base, 2 ft. high, where I-

Set an iron post, 3 ft. long, 1 in. diam., 28 ins. in the ground, for cor. No. 1 of the Richmond, with brass cap mkd.



1933

raise a mound of stone, 3 ft. base, 2 ft. high, in angle on claim.

From this point the 1/4 sec. cor. bet. secs. 8 and 9, T. 1 S., R. 3 E., bears N. 76° 53' E., 21.95 chs. dist.; an iron post, 1 in. diam., 12 ins. above ground, firmly set, mkd. and witnessed as described in the official record.

Thence

N. 70° 56' W.. along bdy. of the Richmond.

Over level land through scattering undergrowth.

- .90 Wash, 20 lks. wide, course NE.
- 3.80 Rocky wash, 60 lks. wide, course NE.
- 4.80 Rocky wash, 100 lks. wide, 3 ft. deep, course NE.
- 6.65 Road, bears NW. and S.
- 10.00 Ascend 51 ft. over SE. slope.
- 17.90 Saddle in spur, slopes NE., descend 35 ft. over NW. slope.
- 18.05 A shaft, 5 x 5 ft., 6 ft. deep, bears S. 20° W., 5 lks. dist.
- 22.72 Set an iron post, 3 ft. long, 1 in. diam., 28 ins. in the ground, for cor. No. 2 of the Richmond, with brass cap mkd.

SURVEY OF THE RICHMOND.

Chains.

1933

raise a mound
of stone, 3 ft. base, 2 ft. high, in angle on claim.

From this point the $\frac{1}{4}$ sec. cor. bet. secs. 7 and 8,
bears West, 30.66 chs. and S. $61^{\circ} 15'$ W., 7.16 chs.
dist.; an iron post, 1 in. diam., standing firmly flush
with the top of a stone mound, 16 ins. high, mkd. and wit-
nessed as described in the official record.

Thence

S. $23^{\circ} 05'$ W., along bdy. of the Richmond.

Along base of spur through scattering undergrowth.

- 1.20 A shallow cut, bears S. 71° E., 80 lks. dist.
- 2.83 Top of low rocky spur, slopes W., descend 20 ft.
- 3.64 Fence, bears E. and W.
- 4.70 Head of draw, course W., ascend 70 ft. over N. slope.
- 9.11 Set an iron post, 3 ft. long, 1 in. diam., 20 ins. in the
ground to bedrock and in a mound of stone to top, for
cor. No. 3 of the Richmond, with brass cap mkd.

1933

raise a mound
of stone, 3 ft. base, 2 ft. high, in angle on claim.

Thence

S. $70^{\circ} 56'$ E., along bdy. of the Richmond.

Ascend over rocky N. slope through scattering undergrowth.

- 2.24 Ridge, bears E. and W., descend over SE. slope.
- 6.90 Fence, bears N. and S.
- 7.50 Wash, 10 lks. wide, 2 ft. deep, course E.
- 14.68 Junction of roads, bears E., W. and NW.
- 18.68 Wash, 50 lks. wide, 3 ft. deep, course E.
- 21.18 Wash, 15 lks. wide, 2 ft. deep, course E.
- 22.72 Set an iron post, 3 ft. long, 1 in. diam., 28 ins. in the
ground, for cor. No. 4 of the Richmond, with brass cap
mkd.

1933

raise a mound
of stone, 3 ft. base, 2 ft. high, in angle on claim.

From this point the location monument bears S. $23^{\circ} 05'$
W., 37 lks. dist.; a mound of stone badly scattered.

SURVEY OF THE RICHMOND.

BOOK 4002

Chains.

Thence

N. 23° 05' E.. along bdy. of the Richmond.

Over level land through scattering undergrowth.

4.55

From this point, a deep shaft, 4 x 6 ft., bears N. 70° 56' W., 10.29 chs. dist.; and at 11.52 chs. the discovery monument; a mound of stone 4 ft. base, 3 ft. high, at W. end of an open cut, 4 ft. wide, 80 ft. long.

9.11

To cor. No. 1 and place of beginning.

Area of the Richmond, 20.65 Acres.

FINAL TEST OF THE SOLAR ATTACHMENT.

For the final test of the solar attachment see the field notes for T. 1 S., R. 4 E. of this group.

GENERAL DESCRIPTION.

The Richmond mining claim lies along and astride of a long low spur sloping easterly. The ground at the west end of the claim is very rough and rocky.

A scattering growth of greasewood, palo verde and juniper represents the ground cover.

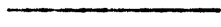

BOOK 4002

CERTIFICATE OF UNITED STATES SURVEYOR

I, Francis E. Joy, U.S. Cadastral Engineer, hereby certify upon honor that, in pursuance of special instructions received from the District Cadastral Engineer for Arizona bearing date of the 5th day of April, 1932, I have well, faithfully, and truly in my own proper person, and in strict conformity with said instructions, the Manual of Surveying Instructions, and the laws of the United States, executed a metes-and-bounds survey of a body of land classified as mineral bearing, included within the Richmond Mining Claim, in Section 8, Township 1 South, Range 3 East,

of the Gila and Salt River Meridian, in the State of Arizona, which are represented in the foregoing field notes as having been executed by me, and under my direction; and that all the corners of metes-and-bounds said survey have been established and perpetuated in strict accordance with the Manual of Surveying Instructions, and the special written instructions of the District Cadastral Engineer for Arizona and in the specific manner described in the field notes, and that the foregoing are the original field notes of such metes-and-bounds survey.

Glendale, California.
July 18, 1933.

Francis E. Joy
U.S. Cadastral Engineer. ~~DELETED~~

APPROVAL

OFFICE OF U. S. SUPERVISOR OF SURVEYS,

Denver, Colorado, November 7, 1933.

The foregoing field notes of the metes-and-bounds survey of a body of land classified as mineral bearing, included within the Richmond Mining Claim, in Section 8, Township 1 South, Range 3 East, of the Gila and Salt River Meridian, in the State of Arizona,

executed by Francis E. Joy, U.S. Cadastral Engineer, under his special instructions dated April 5, 1932, having been critically examined, and the necessary corrections and explanations made, the said metes-and-bounds field notes, and the surveys they describe, are hereby approved.

[Signature]
U. S. Supervisor of Surveys.

~~I certify that the foregoing transcript of the field notes of the above described surveys in _____, has been correctly copied from the original notes on file in this office.~~

~~U. S. Supervisor of Surveys.~~