

UNITED STATES  
DEPARTMENT OF THE INTERIOR  
BUREAU OF LAND MANAGEMENT

Indexed ✓

(1)

Original

4395

# FIELD NOTES

of the Survey of

Tract 37 in Section 13

and Tracts 38 and 39 in Section 22

Township 8 South, Range 17 West

Of the Gila and Salt River Meridian,

In the State of Arizona.

### EXECUTED BY

Clark Gumm, Cadastral Engineer

Under special instructions dated April 1, 1952, which provided  
for the surveys included under Group No. 283, approved April 3, 1952  
and assignment instructions dated April 4, 1952.

Survey commenced April 9, 1952.

Survey completed April 11, 1952.

4395

# INDEX DIAGRAM

Township \_\_\_\_\_, Range \_\_\_\_\_

6	5	4	3	2	1
7	8	9	10	11	12
18	17	16	15	14	13
19	20	21	22	23	24
30	29	28	27	26	25
31	32	33	34	35	36

11A

BOOK 4395

TOWNSHIP 8 SOUTH, RANGE 17 WEST

Section 13

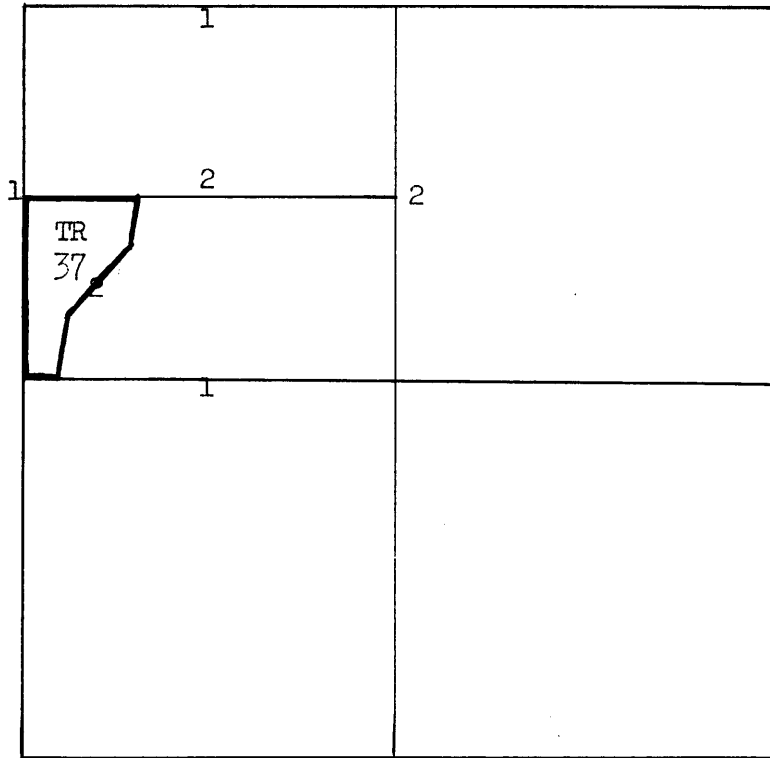

Section 22

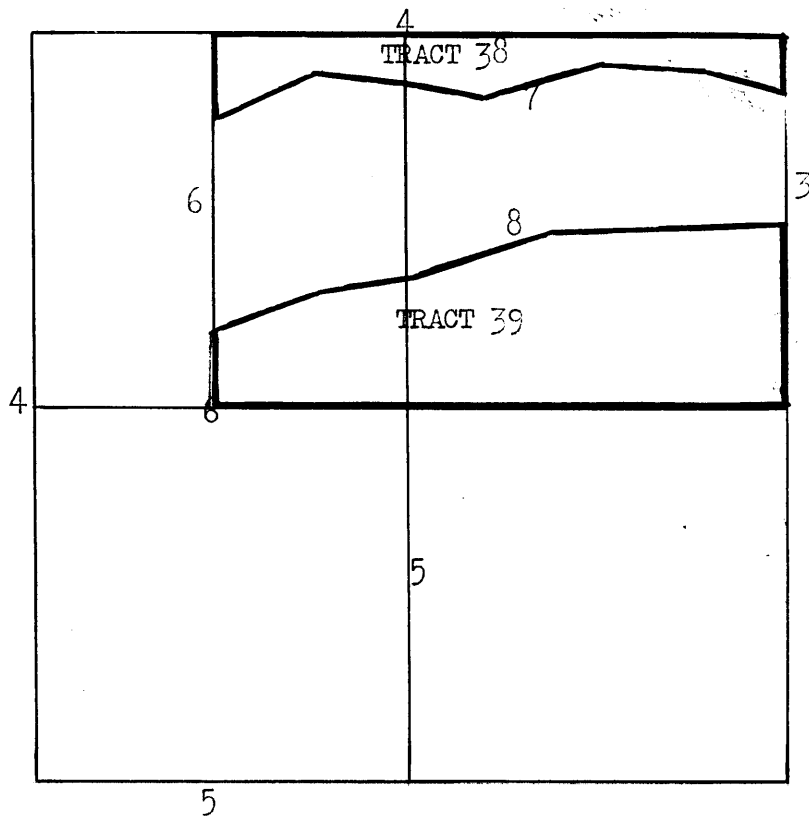

Survey of Tracts 37, 38, and 39, T.8S., R.17W., G. and S. R. M., Ariz.

Chains

For a description of methods employed and conditions peculiar to this survey, see the introduction to the field notes of the survey of Tract 37, T. 7 S., R. 16 W. The subdivisional lines of this township were originally surveyed by J. L. Harris, Deputy Surveyor, in 1878 as shown upon the plat of T. 8 S., R. 17 W., approved April 1, 1878.

Survey of Tract 37 in Sec. 13, T. 8 S., R. 17 W.

From the  $\frac{1}{4}$  sec. cor. of secs. 12 and 13, which is monumented with a B. R. (Bureau of Reclamation) iron post, 1 in. diam., set 8 ins. out of ground, with brass cap mkd.

S12  
 $\frac{1}{4}$  ———  
 S13  
 1949

S. 89° 08.5' W., bet. secs. 12 and 13.

Over sandy bottom land.

- 5.00 Poorly defined left edge of Gila River wash. Thence across channel.
- 15.00 Right edge of channel, bears generally N. and S.
- 39.955 The cor. of secs. 11, 12, 13, and 14, which is monumented with a B. R. iron post, 2 ins. diam., set 1 ft. below surface of ground, with brass cap mkd.

T7S R17W  
 S11 | S12  
 ———  
 S14 | S13  
 1941

S. 0° 26.7' E., bet. secs. 13 and 14.

Across fallow land.

- 19.98 The N  $\frac{1}{16}$  sec. cor. of secs. 13 and 14, which is also angle point 2 of Tract 37 and is monumented with a B. R. iron post, 1 in. diam., set 1 ft. below surface of ground, with brass cap mkd.

N  $\frac{1}{16}$   
 S14 | S13  
 (No date)

Thence along W. bdy. of Tract 37, continuing measurement.

- 27.50 Dike, bears generally NNE. and SW. Leave fallow land.

- 39.98 The  $\frac{1}{4}$  sec. cor. of secs. 13 and 14, which is also angle point 3 of Tract 37 and is monumented with a B. R. iron post, 1 in. diam., set 8 ins. out of ground, with brass cap mkd.

$\frac{1}{4}$   
 S14 | S13  
 1949

N. 89° 10.5' E., on E. and W. center line of sec. 13 (W  $\frac{1}{2}$ ) and along S. bdy. of Tract 37.

- 4.43 Point for angle point 4 of Tract 37, on old well defined bank of Gila River.

## Survey of Tract 37 in Sec. 13, T. 8 S., R. 17 W.

Chains	
	<p>Set a B. R. iron post, 3 ft. long, 2 ins. diam., 28 ins. in ground, with brass cap mkd.</p> <p style="text-align: center;"> <math display="block">\begin{array}{r} \text{TR37} \\ \text{AP4} \end{array} / \begin{array}{l} \text{T8S} \\ \text{R17W} \\ \text{S13} \\ 1952 \end{array}</math> </p> <p>Thence leave S. bdy. of Tract, continuing measurement.</p>
12.30	Present right edge of Gila River wash, bears generally NNE. and WSW. Thence across wash.
25.00	Left edge of Gila River wash.
39.89	The C $\frac{1}{4}$ sec. cor. of sec. 13, which is monumented with a 3x4 in. sawed post, set 1 ft. above ground and branded C $\frac{1}{4}$ on S. face, 1949 on W. face, and S13 on N. face.
	N. 0° 20.5' W., on N. and S. center line of sec. 13 (N $\frac{1}{2}$ )
20.00	Point for the CN 1/16 sec. cor. of sec. 13, at proportionate dist. Position not monumented.
40.00	The $\frac{1}{4}$ sec. cor. of secs. 12 and 13.
	From the point for the CN 1/16 sec. cor. of sec. 13.
	S. 89° 10.5' W., on the E. and W. center line of the NW $\frac{1}{4}$ of sec. 13.
15.50	Left edge of Gila River wash, bears NNE. and SSW.
19.00	Right edge of wash.
25.12	Point for angle point 1 of Tract 37.
	Set a B. R. iron post, 3 ft. long, 1 in. diam., 28 ins. in ground, with brass cap mkd.
	$\begin{array}{r} \text{T8S R17W} \\ \text{AP1} \end{array} / \begin{array}{l} \text{S13} \\ \text{TR37} \\ 1952 \end{array}$
	Thence along N. bdy. of Tract 37, continuing measurement.
38.70	Top of dike, bears N. and curves to SW.
39.92	The N 1/16 sec. cor. of secs. 13 and 14, which is also angle point 2 of Tract 37.
	From angle point 4 of Tract 37.
	N. 12° 59' E., along E. bdy. of Tract 37, traversing (not meandering) along an old river bank.
9.05	Point for angle point 5 of Tract 37.
	Set a B. R. iron post, 1 in. diam., 3 ft. long, 28 ins. in ground, with brass cap mkd.
	$\begin{array}{r} \text{TR37} \\ \text{AP5} \end{array} / \begin{array}{l} \text{T8S} \\ \text{R17W} \\ \text{S13} \\ 1952 \end{array}$
	Thence, N. 49° 48' E., beginning new measurement.
8.47	Point for angle point 6 of Tract 37.

## Survey of Tract 37 in Sec. 13, T. 8 S., R. 17 W.

Chains

Set a B. R. iron post, 3 ft. long, 1 in. diam., 28 ins. in ground, with brass cap mkd.

TR37 / T8S  
AP6 / R17W  
S13  
1952

Thence, N. 16° 15' E., beginning new measurement.

6.10 Angle point 1 of Tract 37.

Note: The area of Tract 37, T. 8 S., R. 17 W., is 18.20 acres and the boundaries are those selected by the Bureau of Reclamation.

Survey of Tracts 38 and 39 in Sec. 22, T. 8 S., R. 17 W.

From the  $\frac{1}{4}$  sec. cor. of secs. 22 and 23, which is also angle point 7 of Tract 39 and is monumented with a B. R. iron post, 1 in. diam., set 8 ins. out of ground, with brass cap mkd.

$\frac{1}{4}$   
S22 | S23

(No date)

Monument is located on steep N. slope.

N. 0° 47.7' E., bet. secs. 22 and 23 and along E. bdy. of Tract 39.

Descend steep sandy N. slope.

0.80 Foot of slope, bears ENE. and WSW. Thence over bottom of valley.

19.985 Point for the N  $\frac{1}{16}$  sec. cor. of secs. 22 and 23, which is also angle point 1 of Tract 39 and is monumented with a stake 2x2 ins. square marked N  $\frac{1}{16}$  S22.

At the point for cor.

Set a B. R. iron post, 3 ft. long, 1 in. diam., 28 ins. in ground, with brass cap mkd.

N  $\frac{1}{16}$   
S22 | S23  
1952

Leave E. bdy. of Tract 39, continuing measurement. Thence over bottom of Gila River wash.

32.17 Point for angle point 9 of Tract 38, on right cut bank of Gila River wash, bears generally E. and W.

Set a B. R. iron post, 3 ft. long, 1 in. diam., 28 ins. in ground, with brass cap mkd.

TR38 / T8S  
AP9 / R17W  
S22 | S23  
1952

38.50 Thence along E. bdy. of Tract 38, continuing measurement. Old dike, bears E. and W.

39.97 The cor. of secs. 14, 15, 22, and 23, which is also angle point 1 of Tract 38 and is monumented with a B. R. iron post, 2 ins. diam., set 8 ins. out of ground, with brass cap mkd.

Survey of Tracts 38 and 39 in Sec. 22, T. 8 S., R. 17 W.

Chains

T8S R17W	
S15	S14
-----	
S22	S23
1941	

S. 89° 22.9' W., bet. secs. 15 and 22 and along N. bdy. of Tract 38.

Over sandy bottom land.

20.33 The E 1/16 sec. cor. of secs. 15 and 22, which is monumented with a B. R. iron post, 1 in. diam., set 10 ins. out of ground, with brass cap mkd.

E 1/16	
S15	-----
S22	
1950	

24.00 Drainage ditch, bears ESE. and WNW.

27.50 Dike, bears NW. and ESE.

40.66 The 1/4 sec. cor. of secs. 15 and 22, which is monumented with a B. R. iron post, 1 in. diam., set 8 ins. out of ground, with brass cap mkd.

1/4	
S15	-----
S22	
1941	

60.99 The W 1/16 sec. cor. of secs. 15 and 22, which is also angle point 2 of Tract 38 and is monumented with a B. R. iron post, 1 in. diam., set 8 ins. out of ground, with brass cap mkd.

W 1/16	
S15	-----
S22	
1950	

Leave N. bdy. of Tract 38, continuing measurement.

81.31 The cor. of secs. 15, 16, 21, and 22, which is monumented with a B. R. iron post, 2 ins. diam, in an eight in. concrete cylinder to cap, and set 6 ins. out of ground, with brass cap mkd.

T8S R17W	
S16	S15
-----	
S21	S22
1941	

S. 0° 00.8' W., bet. secs. 21 and 22

Over sandy bottom land.

7.90 Old river bank, bears NE. and SW. Thence over bottom of Gila River wash. The wash edges are not clearly marked.

39.845 The 1/4 sec. cor. of secs. 21 and 22, which is monumented with a B. R. iron post, 1 in. diam., set 8 ins. out of ground, with brass cap mkd.

1/4	
S21	S22
-----	
1949	

Monument is set in bottom of wash.

## Survey of Tracts 38 and 39 in Sec. 22, T. 8 S., R. 17 W.

Chains	
42.00	Present left edge of Gila River wash, bears ENE. and WSW.
55.00	Old river bank, bears ENE. and WSW.
60.00	S. edge of valley, bears ENE. and WSW. Ascend sandy N. slope 60 ft.
61.00	Top of slope. Thence over gently rolling top.
79.69	The cor. of secs. 21, 22, 27, and 28, which is monumented with a B. R. iron post, 2 ins. diam., set 8 ins. out of ground, with brass cap mkd.
	$\begin{array}{r} \text{T8S R17W} \\ \text{S21} \mid \text{S22} \\ \hline \text{S28} \mid \text{S27} \\ 1941 \end{array}$
	N. 89° 32.6' E., bet. secs. 22 and 27 (W $\frac{1}{2}$ )
	Over gently rolling mesa top.
20.055	The W $\frac{1}{16}$ sec. cor. of secs. 22 and 27, which is monumented with a B. R. iron post, 1 in. diam., set 8 ins. out of ground, with brass cap mkd.
	$\begin{array}{r} \text{S22} \\ \text{W } \frac{1}{16} \text{---} \\ \text{S27} \\ 1950 \end{array}$
40.11	The $\frac{1}{4}$ sec. cor. of secs. 22 and 27, which is monumented with a B. R. iron post, 1 in. diam., set 8 ins. out of ground, with brass cap mkd.
	$\begin{array}{r} \text{S22} \\ \frac{1}{4} \text{---} \\ \text{S27} \\ 1941 \end{array}$
	N. 0° 24.8' E., on N. and S. center line of sec. 22.
	Over gently rolling mesa top.
26.00	Edge of mesa, bears ENE. and WSW. Descend sandy N. slope 60 ft.
29.50	Foot of slope. Thence over valley bottom.
39.905	The C $\frac{1}{4}$ sec. cor. of sec. 22, which is monumented with a B. R. iron post, 1 in. diam., set 8 ins. out of ground, with brass cap mkd.
	$\begin{array}{r} \text{C } \frac{1}{4} \text{ S22} \\ 1949 \end{array}$
	Thence across Tract 39, continuing measurement.
54.46	Point for angle point 3 of Tract 39, on left bank of Gila River wash, which bears E. and W.
	Set a B. R. iron post, 3 ft. long, 1 in. diam., 28 ins. in ground, with brass cap mkd.
	$\begin{array}{r} \text{T8S R17W} \\ \text{S22} \\ \hline \text{AP3} \\ \text{TR39} \\ 1952 \end{array}$
	Leave Tract 39, continuing measurement. Thence across bottom of wash.
75.115	Point for angle point 5 of Tract 38, on right bank of Gila River Wash,



## Survey of Tracts 38 and 39 in Sec. 22, T. 8 S., R. 17 W.

Chains	
	which bears E. and W.
	Set a B. R. iron post, 3 ft. long, 1 in. diam., 28 ins. in ground, with brass cap mkd.
	<div style="text-align: center;">           TR38            AP5  <hr style="width: 50px; margin: auto;"/>           T8S R17W            S22            1952         </div>
	Thence across Tract 38, continuing measurement.
79.81	The $\frac{1}{4}$ sec. cor. of secs. 15 and 22.
	From the $\frac{1}{4}$ sec. cor. of secs. 21 and 22.
	N. 89° 27.8' E., on E. and W. center line of sec. 22.
	Across bottom of Gila River wash.
6.00	Left cut bank of Gila River wash, bears ENE. and WSW.
20.19	Point for the CW 1/16 sec. cor. of sec. 22, at proportionate dist., which is also angle point 6 of Tract 39.
	Set a B. R. iron post, 3 ft. long, 1 in. diam., 28 ins. in ground, with brass cap mkd.
	<div style="text-align: center;">           CW 1/16 S22            1952         </div>
	Thence along S. bdy. of Tract 39, continuing measurement.
40.38	The C $\frac{1}{4}$ sec. cor. of sec. 22.
67.00	S. edge of valley. Ascend N. sandy slope 70 ft. to $\frac{1}{4}$ sec. cor.
80.76	The $\frac{1}{4}$ sec. cor. of secs. 22 and 23.
	From the W 1/16 sec. cor. of secs. 15 and 22, and angle point 2 of TR38.
	S. 0° 12.3' W., on the N. and S. center line of the NW $\frac{1}{4}$ of sec. 22 and along the W. bdy. of Tract 38.
8.87	Point for angle point 3 of Tract 38, on right bank of Gila River wash, which bears generally NE. and SW.
	Set a B. R. iron post, 3 ft. long, 1 in. diam., 28 ins. in ground, with brass cap mkd.
	<div style="text-align: center;">           T8S R17W            S22            1952  <div style="display: inline-block; vertical-align: middle; border-left: 1px solid black; border-bottom: 1px solid black; padding-left: 5px; padding-bottom: 5px;">             TR38              AP3           </div> </div>
	Thence leave W. bdy. of Tract 38 and continue measurement over bottom of Gila River wash.
30.11	Point for angle point 5 of Tract 39 on left bank of Gila River wash, which bears generally ENE. and WSW.
	Set a B. R. iron post, 3 ft. long, 1 in. diam., 28 ins. in ground, with brass cap mkd.
	<div style="text-align: center;">           T8S R17W            S22            1952  <div style="display: inline-block; vertical-align: middle; border-left: 1px solid black; border-bottom: 1px solid black; padding-left: 5px; padding-bottom: 5px;">             AP5              TR39           </div> </div>

## Survey of Tract 38 and 39 in Sec. 22, T. 8 S., R. 17 W.

Chains

	Thence along W. bdy. of Tract 39, continuing measurement.
39.87	The CW 1/16 sec. cor. of sec. 22 which is also angle point 6 of Tract 39.
	From angle point 3 of Tract 38.
	N. 69° 25' E., along S. bdy. of Tract 38, traversing (not meandering) the general left bank of the Gila River wash.
13.10	Point for angle point 4 of Tract 38.
	Set a B. R. iron post, 3 ft. long, 1 in. diam., 28 ins. in ground, with brass cap mkd.
	Thence S. 88° 33' E., beginning new measurement.
8.06	Angle point 5, previously described.
	Thence S. 82° 01' E., beginning new measurement.
8.67	Point for angle point 6 of Tract 38.
	Set a B. R. iron post, 3 ft. long, 1 in. diam., 28 ins. in ground, with brass cap mkd.
	Thence N. 84° 31' E., beginning new measurement.
10.68	Point for angle point 7 of Tract 38.
	Set a B. R. iron post, 3 ft. long, 1 in. diam., 28 ins. in ground, with brass cap mkd.
	Thence S. 89° 16' E., beginning new measurement.
9.64	Point for angle point 8 of Tract 38.
	Set a B. R. iron post, 3 ft. long, 1 in. diam., 28 ins. in ground, with brass cap mkd.
	Thence S. 78° 38' E., beginning new measurement.
11.95	Angle point 9 of Tract 38, previously described.
	From angle point 1 of Tract 39.

## Survey of Tracts 38 and 39 in Sec. 22, T. 8 S., R. 17 W.

## Chains

S.  $87^{\circ} 31'$  W., along the N. bdy. of Tract 39, traversing (not meandering) the general left edge of the Gila River wash.

24.13 Point for angle point 2 of Tract 39.

Set a B. R. iron post, 3 ft. long, 1 in. diam., 28 ins. in ground, with brass cap mkd.

T8S R17W  
S22

AP2  
TR39  
1952

Thence S.  $73^{\circ} 50'$  W., beginning new measurement.

17.11 Angle point 3 of Tract 39, previously described.

Thence S.  $82^{\circ} 00'$  W., beginning new measurement.

6.59 Point for angle point 4 of Tract 39.

Set a B. R. iron post, 3 ft. long, 1 in. diam., 28 ins. in ground, with brass cap mkd.

T8S R17W  
S22

AP4  
TR39  
1952

Thence S.  $73^{\circ} 30'$  W., beginning new measurement.

14.325 Angle point 5 of Tract 39, previously described.

Note: The area of Tract 38, T. 8 S., R. 17 W. is 35.00 acres and the area of Tract 39, T. 8 S., R. 17 W. is 99.96 acres and the boundaries are those selected by the Bureau of Reclamation.

4-680  
(Feb., 1950)

UNITED STATES  
DEPARTMENT OF THE INTERIOR  
BUREAU OF LAND MANAGEMENT

BOOK 4395

FIELD ASSISTANTS

NAMES	CAPACITY
<u>Employees of Bureau of Reclamation</u>	

CERTIFICATE OF CADASTRAL ENGINEER

I, Clark Gumm, HEREBY CERTIFY upon honor that, in pursuance of special instructions bearing date of the 1st day of April, 1952, I have surveyed Tract 37 in Section 13 and Tracts 38 and 39 in Section 22, Township 8 South, Range 17 West

of the G. and S. R. Meridian, in the State of Arizona, which are represented in the foregoing field notes as having been executed by me and under my direction; and that said survey has been made in strict conformity with said instructions, the Manual of Instructions for the Survey of the Public Lands of the United States, and in the specific manner described in the foregoing field notes.

Albuquerque, New Mexico
May 8, 1952

Clark Gumm
Clark Gumm
Cadastral Engineer

CERTIFICATE OF APPROVAL

BUREAU OF LAND MANAGEMENT,
Washington, D. C., JUL 7 1952, 19

The foregoing field notes of the survey of Tract 37 in Section 13 and Tracts 38 and 39 in Section 22, Township 8 South, Range 17 West of the Gila and Salt River Meridian, Arizona

executed by Clark Gumm
having been critically examined and found correct, are hereby approved.

Garland G. Harrington
Chief, Division of Cadastral Engineering.

CERTIFICATE OF TRANSCRIPT

That the foregoing transcript of the field notes of the above described surveys in is a true copy of the original field notes.

Chief, Division of Cadastral Engineering