

RECEIVED  
BUREAU OF LAND MANAGEMENT

1953 JUL 31 AM 9:14

ORIGINAL

BOOK 4411

REGION V. OF THE UNITED STATES  
PHOENIX, ARIZONA DEPARTMENT OF THE INTERIOR  
BUREAU OF RECLAMATION

4411

# FIELD NOTES

of the Survey of

Lots 1 and 2 in Section 12

Township 8 South, Range 18 West

Of the G. & S. R. Meridian, In the State of Arizona

## EXECUTED BY

Albin H. Wadin, General Engineer

United States Bureau of Reclamation

Under authority of Departmental Instructions of October 24, 1906.

Survey Commenced December 15 19 52

Survey Completed December 18 19 52

4411

1A

ECCX 4411

# INDEX DIAGRAM

Township 8 South, Range 18 West

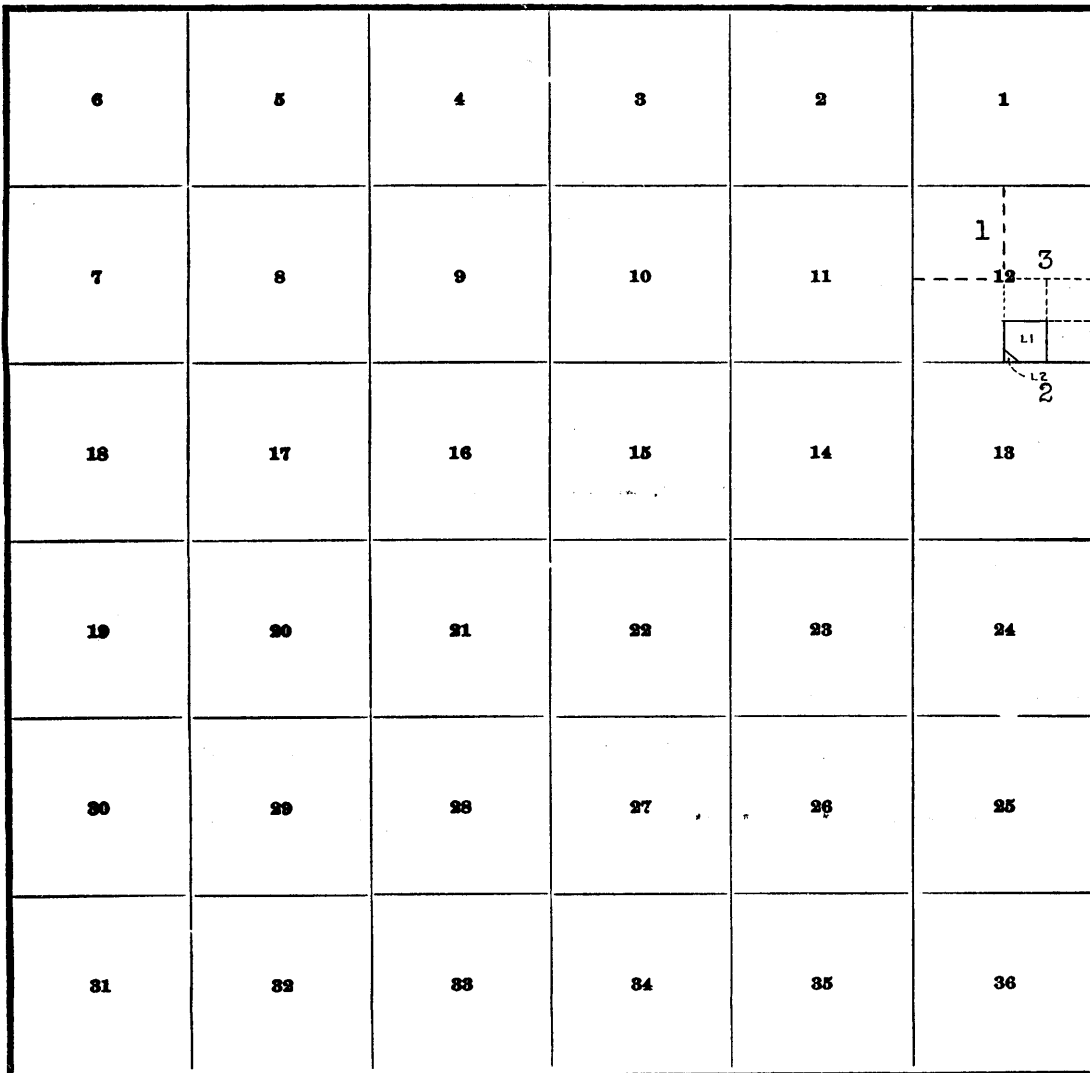

## FIELD ASSISTANTS

NAMES	CAPACITY
E. A. Haley	Instrumentman
G. F. Carr, Jr.	Chairman

Survey of Lots 1 and 2, Section 12, T. 8 S., R. 18 W., G. & S. R. M., Arizona

The purpose of this survey is to subdivide the SE $\frac{1}{4}$  of Section 12 into legal subdivisions and fractional lots, to accommodate a farm unit. The land was acquired from the Gila Valley Power District in connection with the development and construction of canals and laterals in the Wellton-Mohawk Division of the Gila Project, Arizona.

Township 8 South, Range 18 West, Gila and Salt River Meridian, Arizona, was surveyed in February, 1878 by John L. Harris. Sub-division lines were also surveyed by John L. Harris in February, 1878. The plat was approved April 1, 1878. A portion of the West boundary of this township was resurveyed in November, 1912 by Sidney E. Blout, the plat of the resurvey being approved July 27, 1914.

The original corners have been perpetuated by private surveyors by replacing the original corner monuments with 4" x 4" redwood posts properly inscribed. This area has been settled for many years and the corners have been recognized and accepted without controversy. During the course of preconstruction surveys for the construction of canals and laterals in the Wellton-Mohawk Division, Bureau of Reclamation engineers have replaced the redwood posts with brass cap monuments to further perpetuate the corner locations. The caps are of accepted standards and bear the legend "Bureau of Reclamation Penalty \$250 For Removal" and are stamped to designate the appropriate corner.

This survey was executed with a Keuffel & Esser transit, serial number 92796, which is equipped with double verniers reading to 30 seconds of arc. The instrument was examined and tested and found to be in good condition and adjustment.

The exterior corners of the section were found in place. The center of the section  $\frac{1}{4}$  corner was set in this survey.

Bearings established and used by the Bureau of Reclamation in this area are based on the U. S. C. & G. S. Western Arizona Grid System, whose central meridian in this zone is 113° 45' west longitude. The bearings in this survey have been corrected to the true meridian and are shown as true bearings, and the lines are true lines.

CHAINS

From the  $\frac{1}{4}$  cor. of secs. 1 and 12, which is monumented by an iron post 1 in. diam., set 8 in. out of ground with brass cap mkd.

$\frac{1}{4}$   $\frac{S1}{S12}$   
1941

S. 00° 20' 24" E., on the N. and S. centerline of sec. 12

40.30 Point for C  $\frac{1}{4}$  cor. sec. 12. Not monumented at this time.

Continuing measurement,

60.45 Point for the CS 1/16 cor. sec. 12, which is angle point 2 of Lot 1. At proportionate distance,

Set iron post 3 ft. long, 1 in. diam., 8 in. out of ground with brass cap mkd.

S12  
CS  
1/16  
1952

Continuing measurement, now on W. boundary of Lot 1.

71.82 N. bank of the Gila River at angle point 3 of Lot 1, and 2 of Lot 2

Set iron post 3 ft. long, 1 in. diam., 8 in. out of ground with brass cap mkd.

Survey of Lots 1 and 2, Section 12, T. 8 S., R. 18 W., G. & S. R. M., Arizona

CHAINS

T8S R18W

AP 3

L 1

S12

AP 2

L 2

1952

Leave Lot 1, continue measurement on W. boundary of Lot 2.

80.60

Point of  $\frac{1}{4}$  cor. of secs. 12 and 13 falling in river bed. Monumented by an iron post 1 in. diam., set 8 in. out of ground with brass cap mkd.

$\frac{1}{4}$

S12

S13

1950

Also angle point 3 of Lot 2.

From the  $\frac{1}{4}$  cor. of secs. 12 and 13, described above.

N. 89° 07' 13" E., along the line bet. secs. 12 and 13, and the S. boundary of Lot 2, begin new measurement.

9.54

to NE bank of Gila River, point for angle point 1 of Lot 2 and angle point 4 of Lot 1.

Set iron post 3 ft. long, 1 in. diam., 8 in. out of ground with brass cap mkd.

T8S R18W

S12

AP 4

AP 1

L 1

L 2

S13

1952

Leave Lot 2, continue measurement on S. boundary of Lot 1.

20.15

to E  $\frac{1}{16}$  cor. of secs. 12 and 13, which is also angle point 5 of Lot 1. This corner is monumented by an iron post 1 in. diam., set 10 in. out of ground with brass cap mkd.

E  $\frac{1}{16}$

S12

S13

1950

Continuing measurement, leaving Lot 1

40.30

Cor. of secs. 7, 12, 13 and 18 which is monumented by an iron post 2 in. diam., set 12 in. out of ground with brass cap mkd.

T8S

R18W

R17W

S 12

S 7

S 13

S 18

1941

From cor. of secs. 7, 12, 13 and 18 described above.

N. 00° 25' 10" W. on line bet. secs. 7 and 12.

19.92

to S  $\frac{1}{16}$  cor. of secs. 7 and 12, monumented by an iron post 1 in. diam., set 8 in. out of ground with brass cap mkd.

## Survey of Lots 1 and 2, Section 12, T. 8 S., R. 18 W., G. &amp; S. R. M., Arizona

CHAINS

S 1/16

S12 | S7

1941

Continuing

39.84 The  $\frac{1}{4}$  cor. of secs. 7 and 12. A brass cap mounted on an iron post 1 in. diam., set 10 in. out of ground and marked

 $\frac{1}{4}$ 

S12 | S7

1941

From the  $\frac{1}{4}$  cor. of secs. 7 and 12 described above, begin new measurement.

S. 89° 45' 16" W., along the E. and W. centerline of sec. 12

20.12 Point for the CE 1/16 cor. of sec. 12. At proportionate distance,

Set iron post, 3 ft. long, 1 in. diam., 8 in. out of ground, with brass cap mkd.

S12

CE

1/16

1952

Continue measurement.

40.24 Point of intersection with N. and S. centerline of sec. 12. Point for the C $\frac{1}{4}$  cor. of sec. 12.

Set iron post, 3 ft. long, 1 in. diam., 8 in. under ground, with brass cap mkd.

S12

C  $\frac{1}{4}$ 

1952

Continuing measurement

80.48 The  $\frac{1}{4}$  cor. of secs. 11 and 12 which is monumented with an iron post 1 in. diam., set 5 in. out of ground, with brass cap mkd.

 $\frac{1}{4}$ 

S11 | S12

1941

From the S 1/16 cor. of secs. 7 and 12 previously described.

S. 89° 26' 14" W., on the E. and W. centerline of the SE $\frac{1}{4}$  of sec. 12

20.14 To point for the SE 1/16 cor. of sec. 12. At intersection with the N. and S. centerline of the SE $\frac{1}{4}$  of sec. 12

Set iron post, 3 ft. long, 1 in. diam., 8 in. out of ground, with brass cap mkd.

S12

SE 1/16

1952

This cor. is also angle point 1 of Lot 1.

Continuing, now on N. line of Lot 1.

## Survey of Lots 1 and 2, Section 12, T. 8 S., R. 18 W., G. &amp; S. R. M., Arizona

## CHAINS

40.28

The CS 1/16 cor. of sec. 12 and angle point 2 of Lot 1, previously described.

---

From the CE 1/16 cor. of sec. 12, previously described.

S. 00° 22' 46" E., on the N. and S. centerline of the SE $\frac{1}{4}$  of sec. 12.

20.04

to the SE 1/16 cor. of sec. 12 and angle point 1 of Lot 1.

Continue measurement, now on the E. line of Lot 1.

40.08

The E 1/16 cor. of secs. 12 and 13 which is also angle point 5 of Lot 1.

---

From angle point 3 of Lot 1 a brass cap previously set and described.

S. 47° 23' 50" E., along the bank of the Gila River, and on the line bet. Lots 1 and 2.

12.80

To angle point 4 of Lot 1 and angle point 1 of Lot 2, a brass cap previously set and described.

---

Note: Area of Lot 1, Section 12, T8S R18W is 36.20 acres  
 Area of Lot 2, 4.27 acres.

(5)

2001 400

CERTIFICATE OF CADASTRAL ENGINEER

I, Albin H. Wadin Bureau of Reclamation, HEREBY CERTIFY upon honor that, under authority of Departmental Instructions of October 24, 1906.

I have surveyed Lots 1 and 2 in Section 12, Township 8 South, Range 18 West

of the Gila and Salt River Meridian, in the State of Arizona, which are represented in the foregoing field notes as having been executed by me and under my direction; and that said survey has been made in strict conformity with the Manual of Instructions for the Survey of Public Lands of the United States, and in the specific manner described in the foregoing field notes.

January 30, 1953  
Yuma, Arizona

Albin H. Wadin  
Albin H. Wadin  
General Engineer

CERTIFICATE OF APPROVAL

Bureau of Reclamation  
Washington, D. C. JUL 17 1953, 19

The foregoing field notes of the Survey of Lots 1 and 2 in Section 12  
Township 8 South, Range 18 West, Gila and Salt River Meridian Arizona

executed by Albin H. Wadin

having been critically examined and found correct, are hereby approved.

J. W. Fuenwagner  
Assistant Commissioner

CERTIFICATE OF TRANSCRIPT

Bureau of Land Management  
Washington, D. C. \_\_\_\_\_, 19

I CERTIFY that the foregoing transcript of the field notes of the above described surveys in

is a true copy of the original field notes.